



QUASAR Contactless Bottle Filler

UV-C LED WATER TREATMENT

NNF2EBQEZ with VersaFilter III and remedi Filter

Cooler to Bottle Filler Conversion Kit for Single and Split-Level
ELKAY EZ8 and LZ8 Water Coolers

INSTALLATION INSTRUCTIONS

Section 1: Getting Started

What's Included:



Assembled
NNF2EBQEZ Cabinet



1/4" Elbow

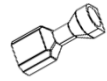

0.25" Terminals
x2



10" of 1/4" OD plastic
tubing with 9" of tubing
insulation

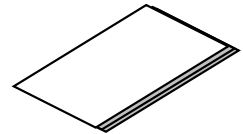

Installation
instructions



Drain Elbow
x2



Side Mounting
Bracket
x2

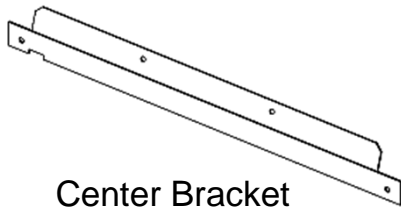

Center Bracket



Strain Relief
P-Clip

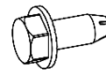

#8 Thread Cutting
Hex Screw

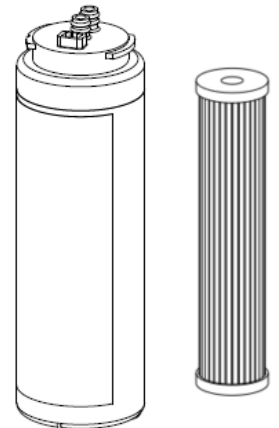

VersaFilter III and
remedi Filter

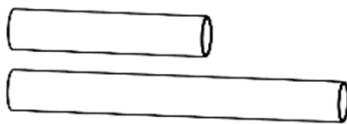

Drainpipe
x2

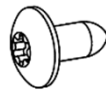

#8 Torx Screws
x3



#10 Hex Screws
x6

Tools & Hardware Required:

- Electric drill/driver
- Small tubing cutter for plastic line
- 5/16" nut driver
- 1/4" nut driver
- Means to cut 1 1/4" drainpipe
- T15 Torx screwdriver or bit
- T20 Torx screwdriver or bit
- 4 appropriate wall anchors (not supplied)

Section 2: IMPORTANT REQUIREMENT

CAUTION: DO NOT ACTIVATE BOTTLE FILLER ELECTRIC EYE SENSOR WITHOUT RUNNING WATER THROUGH THE UV-C MODULE. OPERATING THE UV-C MODULE DRY MAY DAMAGE THE UV-C LED'S.

Section 3A: QUASAR® UV-C LED OPERATION

1. QUASAR is a form of dispense point water treatment that utilizes UV-C LED's to inactivate pathogens.
2. Operation:
 - a. The QUASAR activation is automatic. The UV-C LED's turn ON when water is dispensed and OFF when the dispense stops.
 - b. During non-use periods the QUASAR automatically cycles ON for ten seconds every ten minutes. This keeps the dispense point more sanitary between use.
 - c. When the QUASAR is ON, the LED light on the front of the alcove near the top will turn BLUE.
 - d. If QUASAR is not working properly, then the LED light on the front of the alcove near the top will be ORANGE. The light will remain ORANGE and the system will not allow water to be dispensed until the problem is resolved.
 - e. **IMPORTANT:** Never operate the QUASAR without water connected to the system. Lack of water can cause the QUASAR to overheat. If it is necessary to activate QUASAR to purge the system of air, then the QUASAR will automatically shut off if it overheats. The QUASAR will resume operation once water begins to flow through it and/or once the module returns to safe operating temperature.

Section 3B: LED Indicator Key

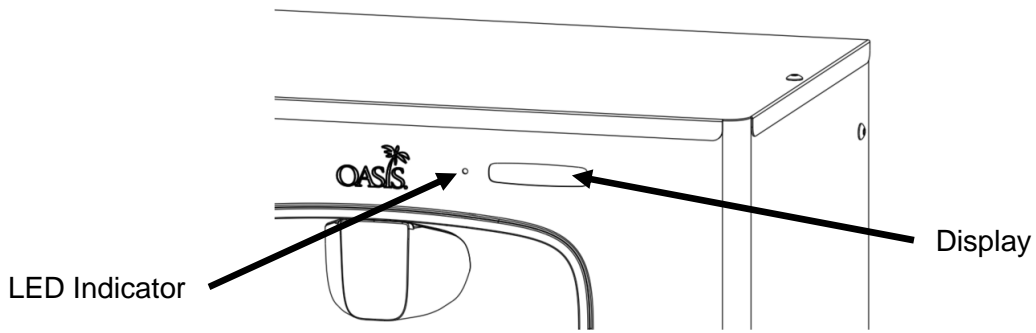

LED Color	Display	Condition	Action
Orange	“UVC OFF- TURN ON WATER SUPPLY”	While dispensing, UVC temperature is too high.	Ensure water supply is ON. If initial start-up: Activate the bottle filler to dispense water. LED will turn BLUE when water flows.
Green	“BOTTLES SAVED”	Standby mode – filter life <80% used.	No action needed.
Yellow	“BOTTLES SAVED”	Standby mode – filter life >80% used but <100%.	Order new filter.
Red	“BOTTLES SAVED”	Standby mode – filter life =100% used.	Replace the filter.
Blue	“UVC DISINFECTION IN PROCESS”	Dispensing – bottle sensed by IR sensor and UVC operating properly.	No action needed.
Orange	“UVC REQUIRES SERVICE” (Remains ON even in standby.)	Water cannot be dispensed.	Check electrical connections to UVC and reset power first. Replace UVC if necessary.

Section 4: Rough In Drawing

NNF2EBQEZ:

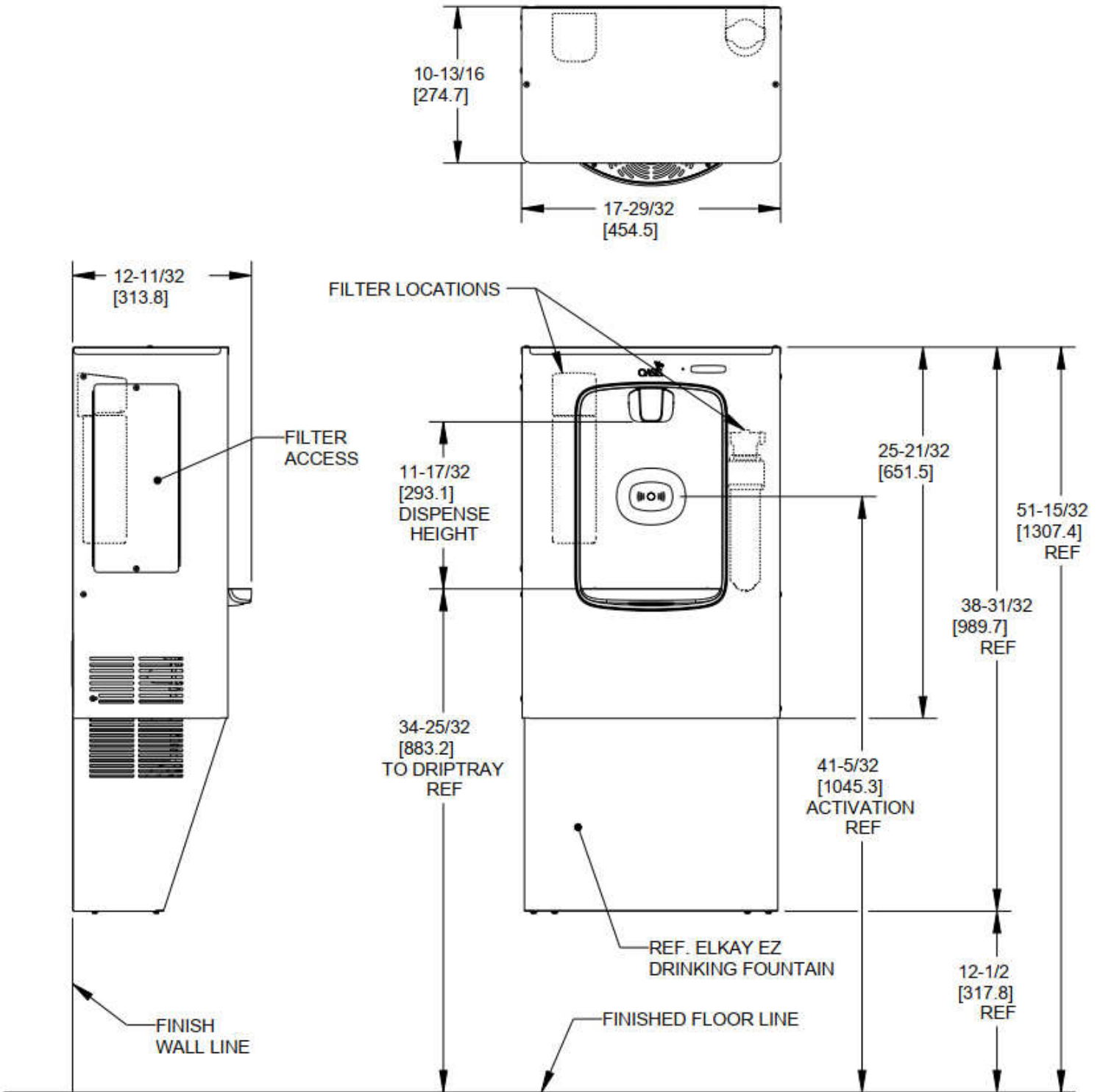

NOTES:

1. ALL DIMENSIONS ARE IN INCHES.
DIMENSIONS IN BRACKETS [] ARE MILLIMETERS.

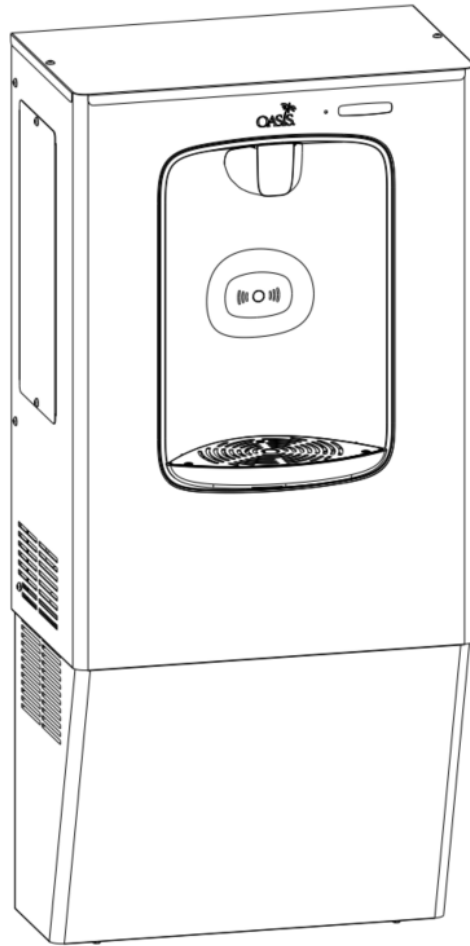

SINGLE LEVEL PREPARATION

- Disassembly of ELKAY Cooler
- Wiring
- Water Lines

Section 5: Preparation

1. Remove fountain wrapper.
2. Turn OFF water supply to the unit.
Bleed any remaining pressure from the lines by activating the bubbler valve.
3. Disconnect power by UNPLUGGING the unit from the wall socket.

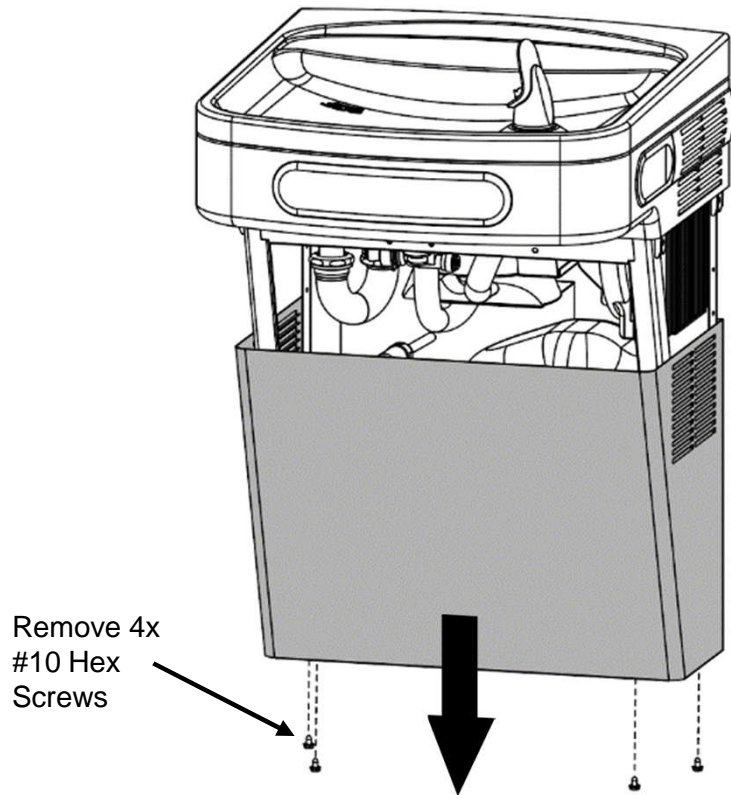

4. Loosen or remove the P-trap so that the fountain nose assembly may be freely removed in the next step.

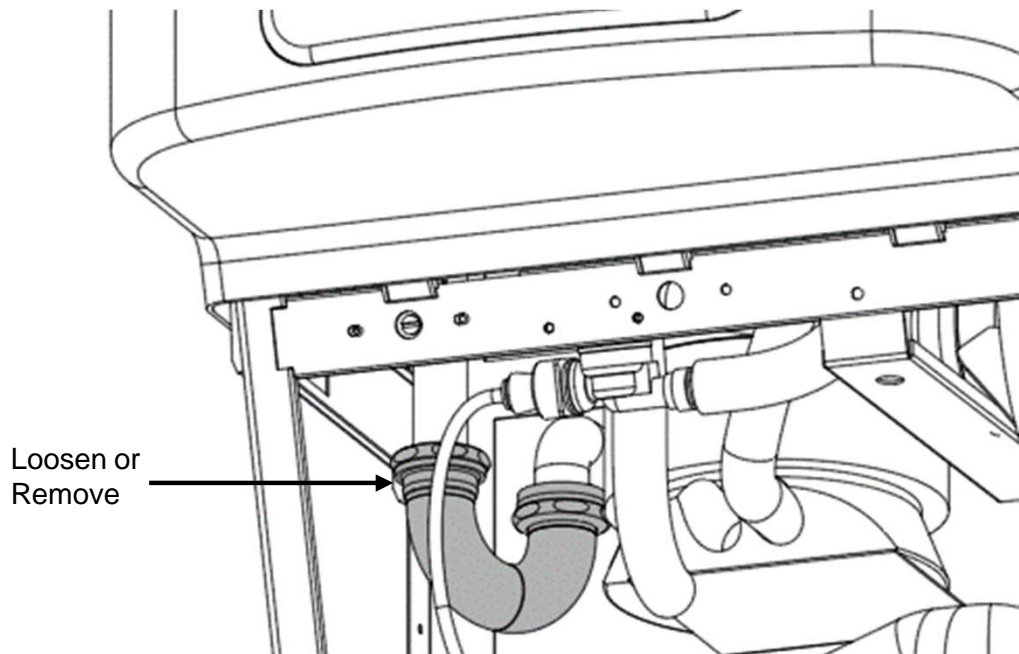

Section 5A: Preparation

5. Remove fountain nose assembly. **Tool Needed: T20 Torx bit**
 - A. Remove 4x #10 Torx screws from the fountain.
 - B. Disconnect **ONLY** the nose assembly wires from the cold control and solenoid valve. Leave all other wires connected to the cold control and solenoid valve. For non-refrigerated models, unplug the unit.
 - C. Disconnect the water line from the bubbler inside the nose. **DO NOT** disconnect from the fountain.

DO NOT REMOVE COLD CONTROL OR SOLENOID VALVE ASSEMBLIES FROM THE FOUNTAIN.

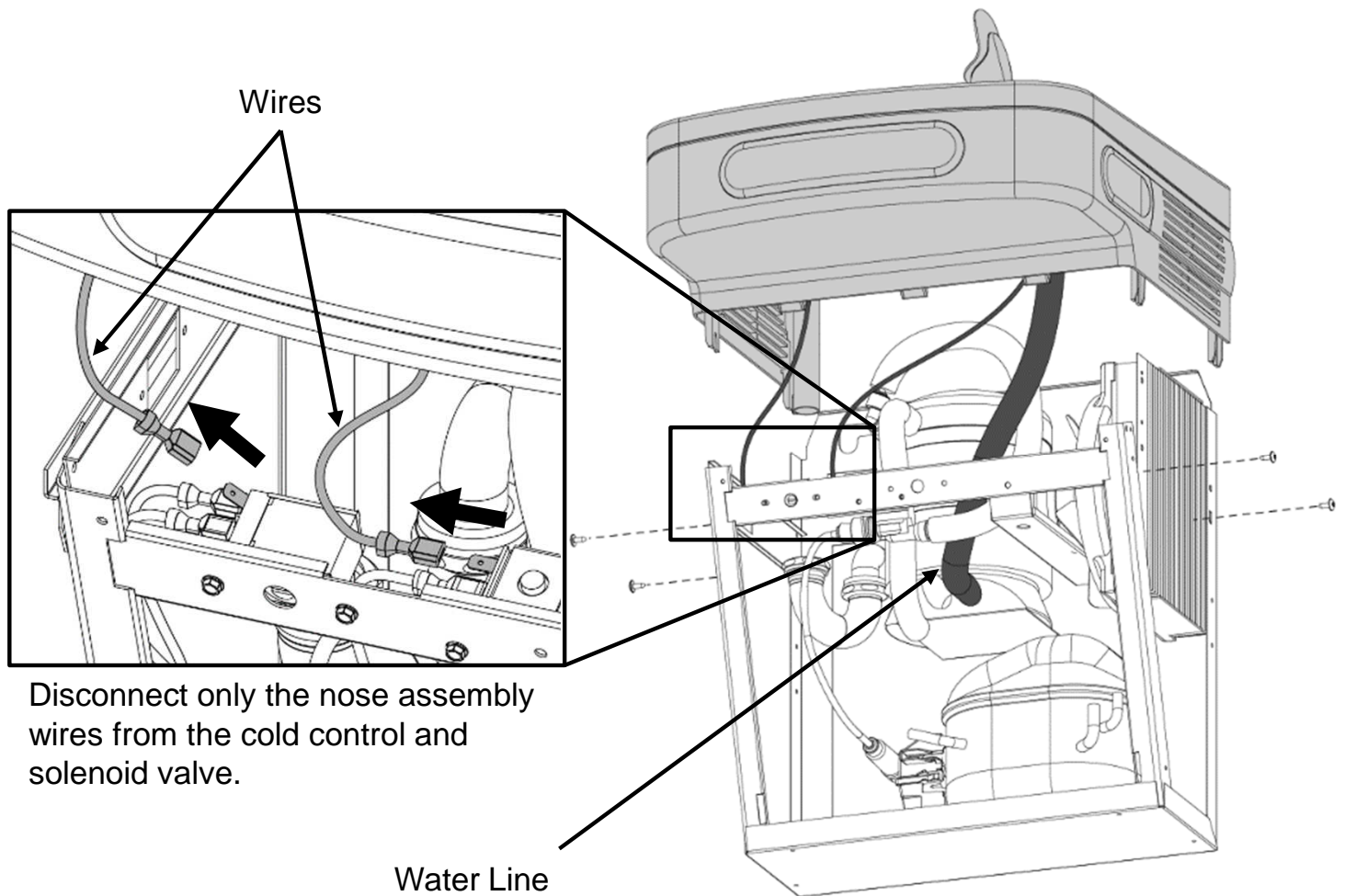

Section 5A: Preparation

6. After the nose assembly has been removed, cover the two bare terminals with the insulated female spade terminals (provided) for safety.

NOTE: The image shown may differ from some models but the instructions will still apply.

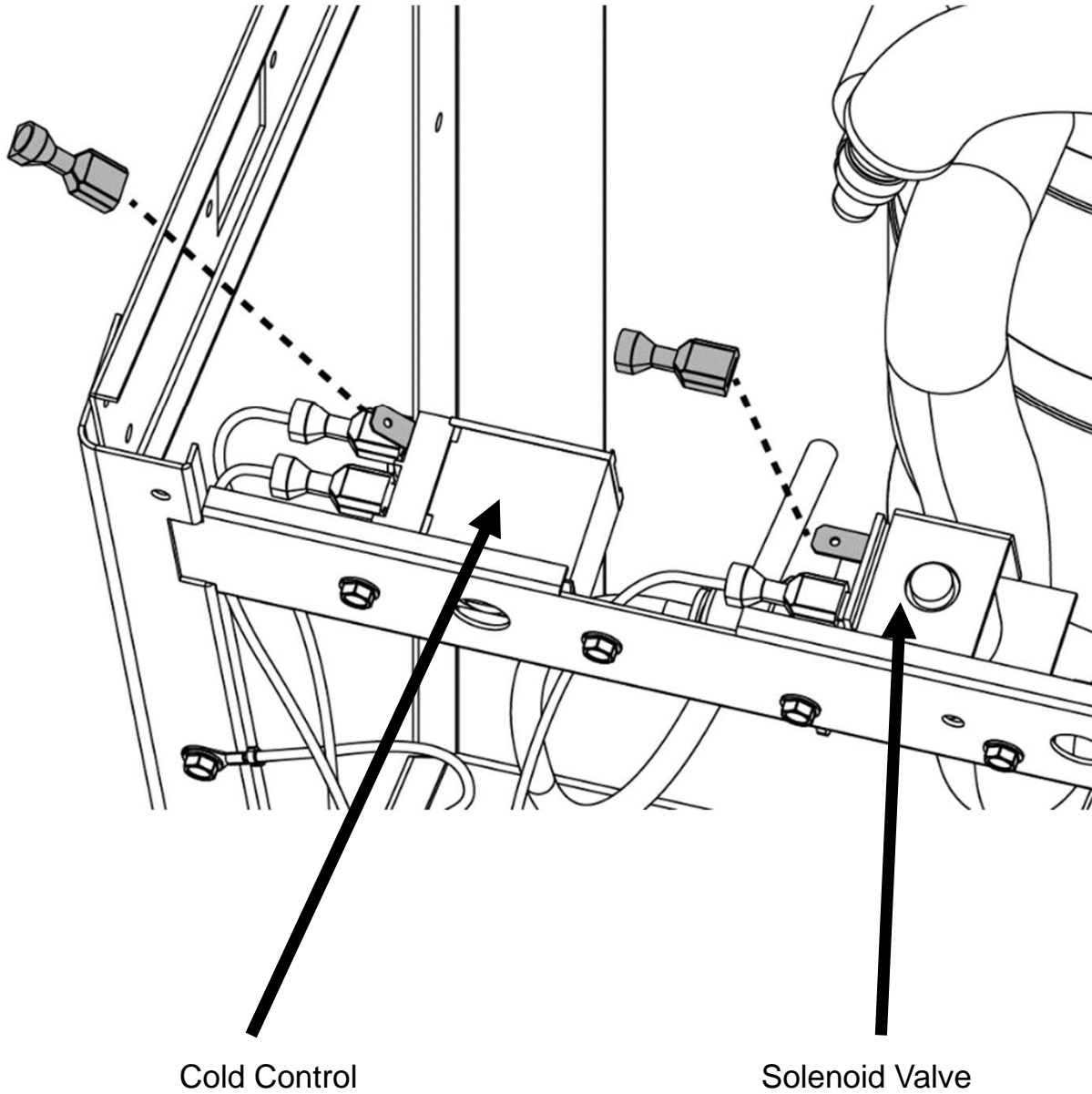

Section 5A: Preparation

7. Model NNF2EBQEZ with VersaFilter III and remedi filter: Locate the solenoid valve on the Elkay unit. Disconnect both water lines from the solenoid valve. Add ¼" elbow fitting (provided) (Fig. 8A) to Cooling Tank Water Line In. Remove 1/4"OD water source line.

Allow the cooling tank water outlet line to extend freely upward (Fig. 7B).

In future steps after the NNF2EBQEZ frame assembly is installed, the Inlet Line on the VersaFilter III head assembly will be connected to the Water Source Fitting (Fig. 7C) and the Outlet Line on the remedi filter head assembly will be connected to the Cooling Tank Water Inlet Elbow Fitting (Fig. 7A).

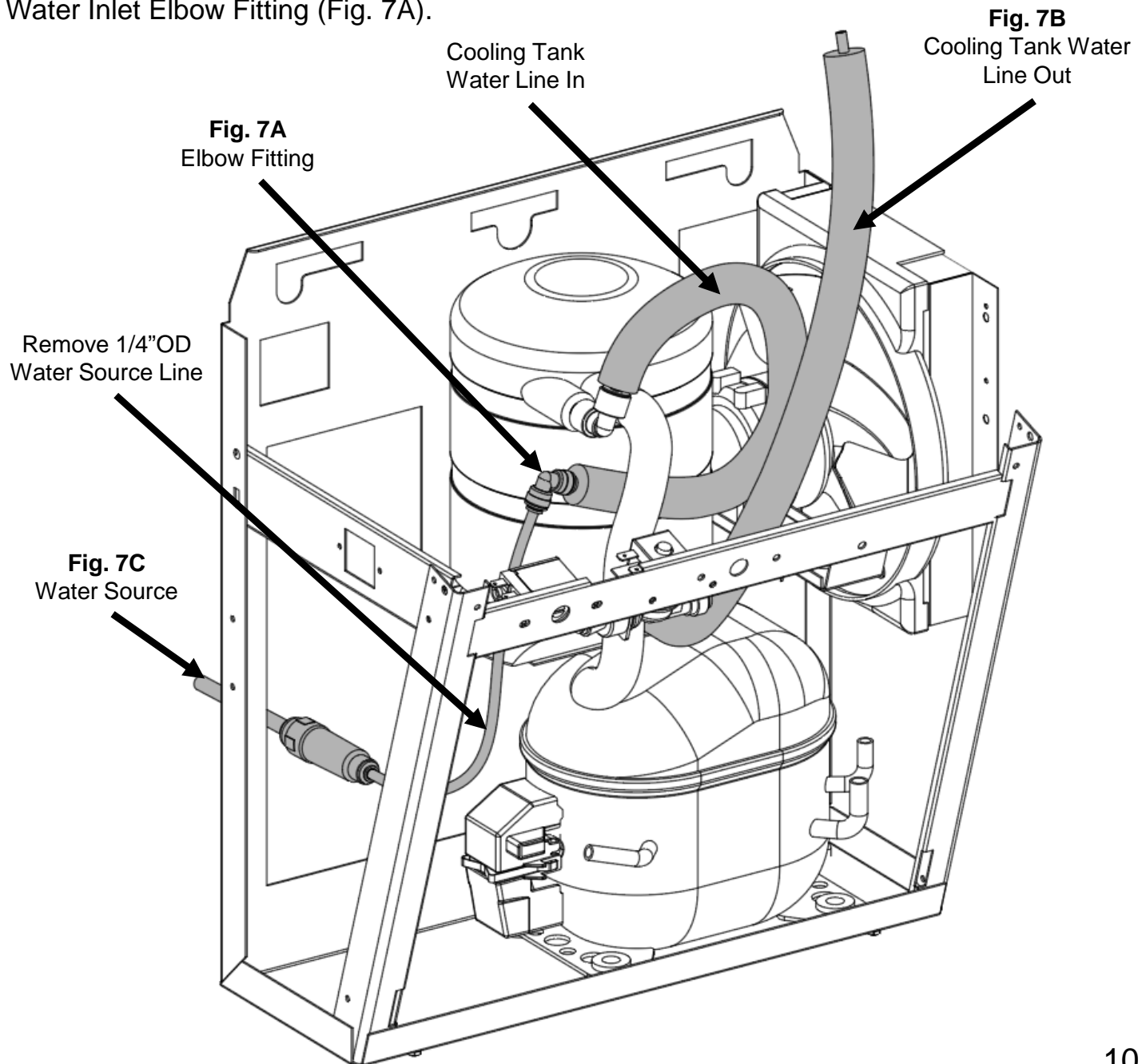

Shown above is the correct final orientation



SINGLE LEVEL INSTALLATION

- Assembly of NNF2EBQEZ Cabinet
- Wiring
- Plumbing

Section 6: Installation

1. The unit come partially assembled for shipping. Remove the kit from the packaging and separate it into the assemblies and components shown below. Filters not shown attached to frame. **Be sure not to misplace the provided mounting screws and insulated terminals.**

Tool Needed: T15 Torx bit

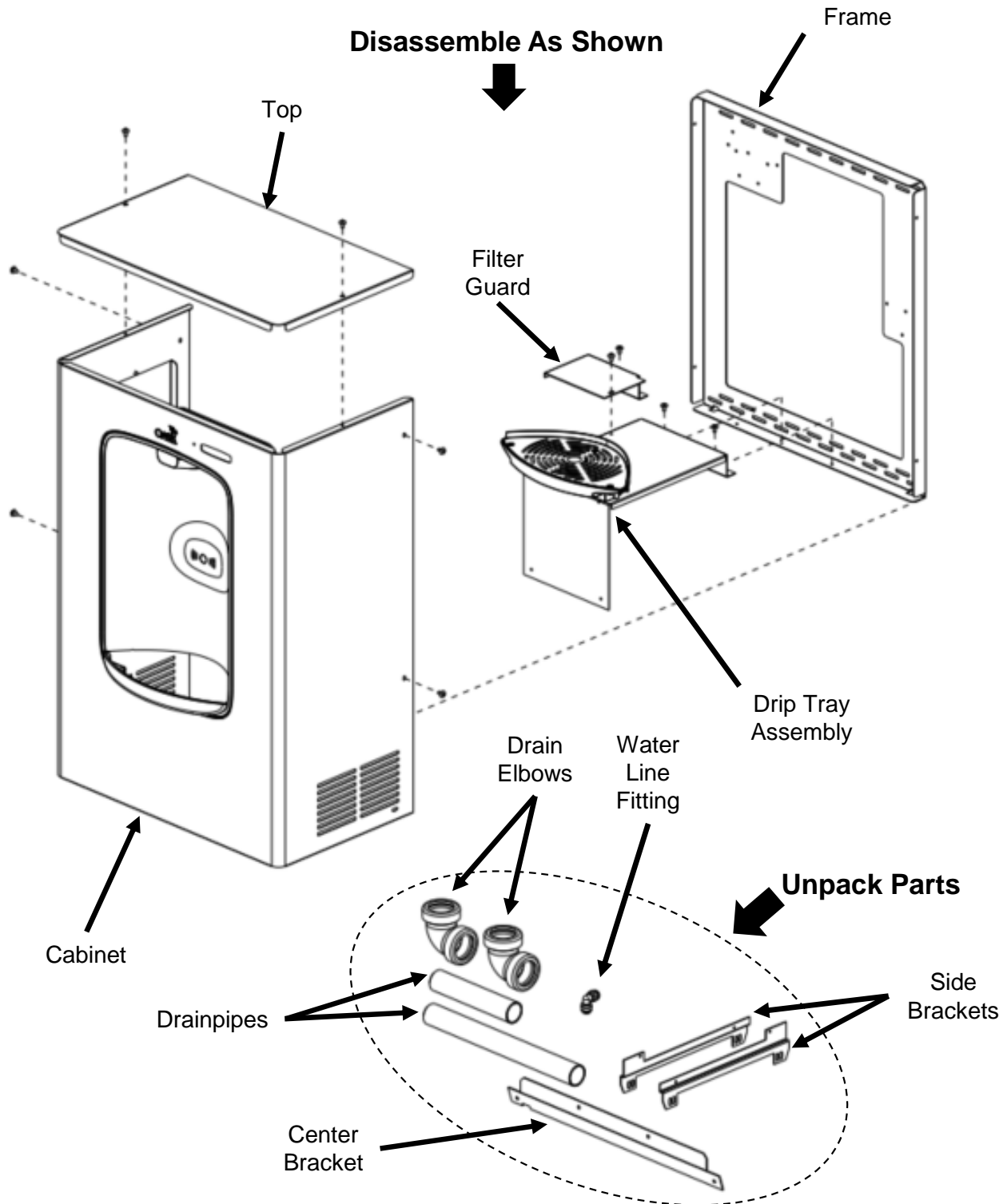

Section 6: Installation

- Without taking the cooler off the wall, place the retrofit frame against the wall and set it onto the top flange of the cooler frame. Filters not shown attached to frame.

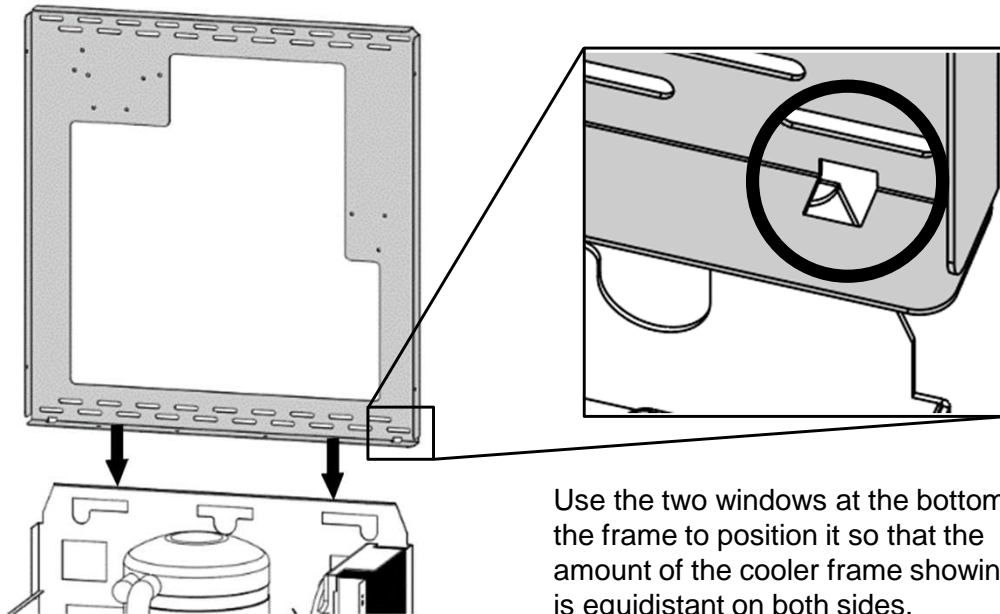

- Affix the frame to the wall with at least 4 anchors into any appropriate anchor points through the staggered slotted holes. **Be careful to ensure the frame stays centered on the cooler frame.**

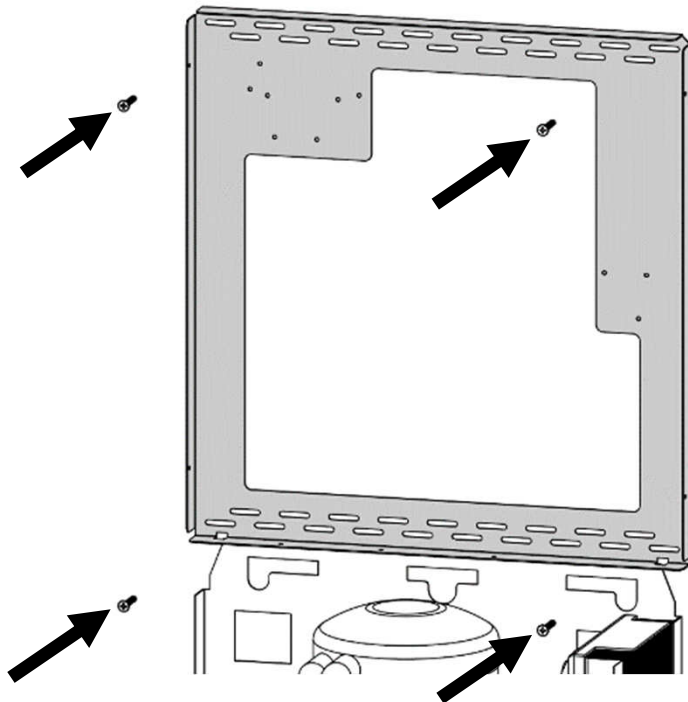

Tx4 **Not Provided.** Use appropriate screws/ Anchors for mounting surface.

Section 6: Installation

4. Assemble the center bracket to the holes in each of the cooler struts.

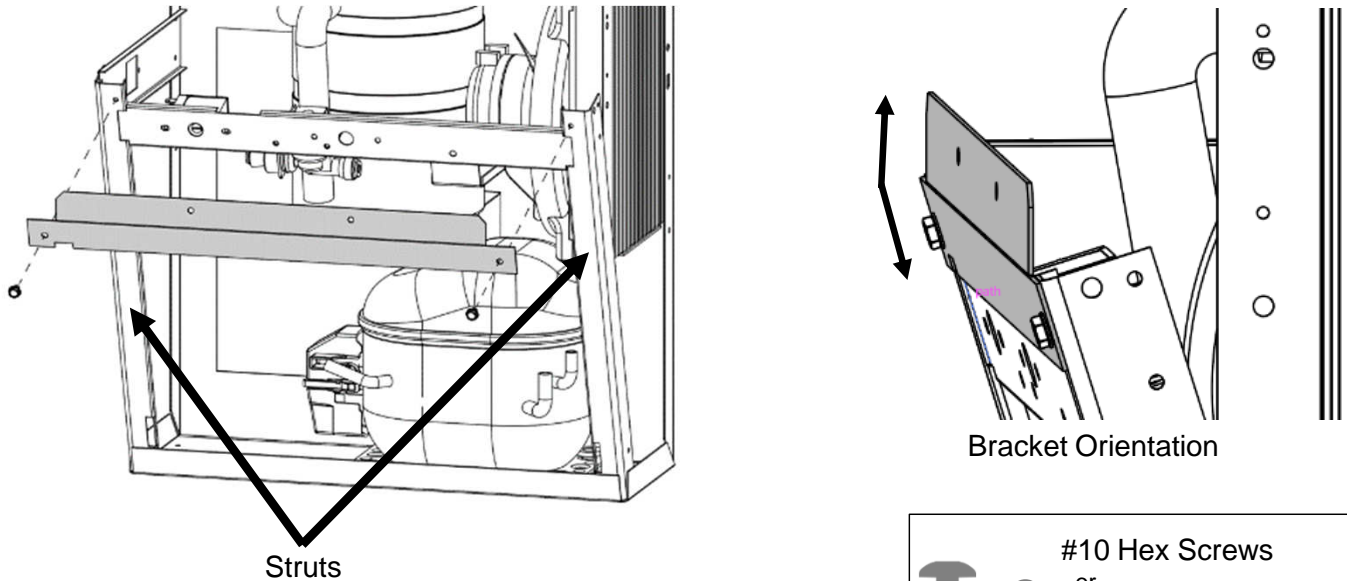

Tx2 #10 Hex Screws
- or -
#10, T20 Torx Screws
(original to fountain unit)

5. Assemble the two side brackets to the cooler frame using the slotted holes on the bottom with two #10 screws for each bracket. Ensure that the brackets are oriented as shown below.

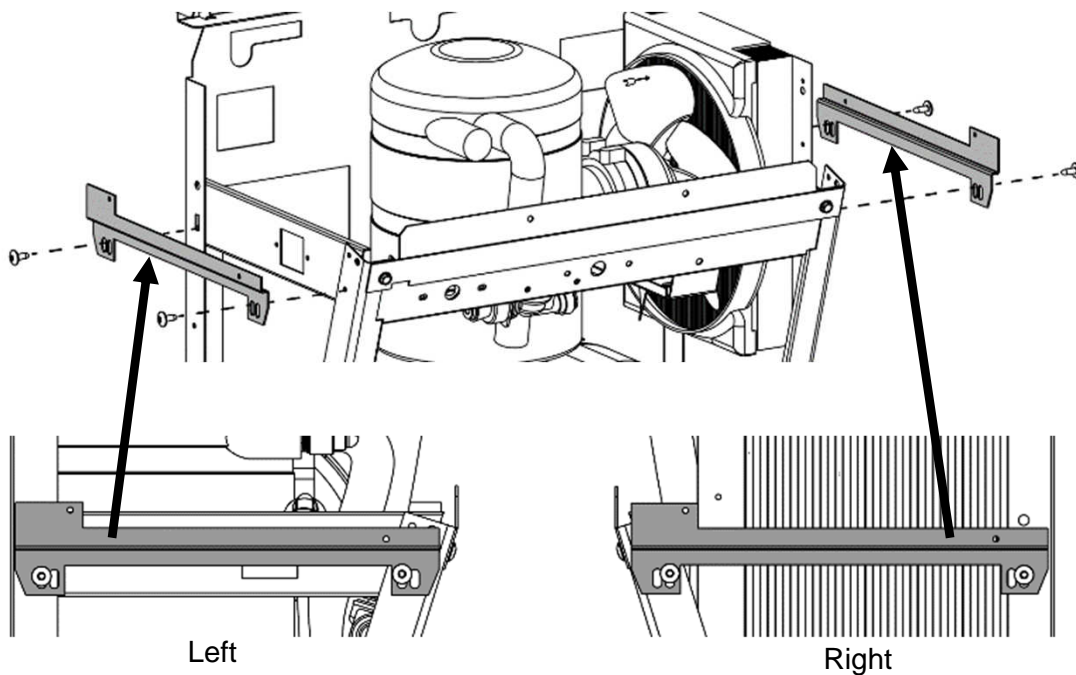

Tx2 #10 Hex Screws (each bracket)
- or -
#10, T20 Torx Screws (each bracket)
(original to fountain unit)

Section 6: Installation

6. Install the drip tray support bracket (keep drip tray pre-assembled) to the center bracket and frame using 4x, #8 Torx screws which are provided in the kit.

Put BEHIND
center bracket

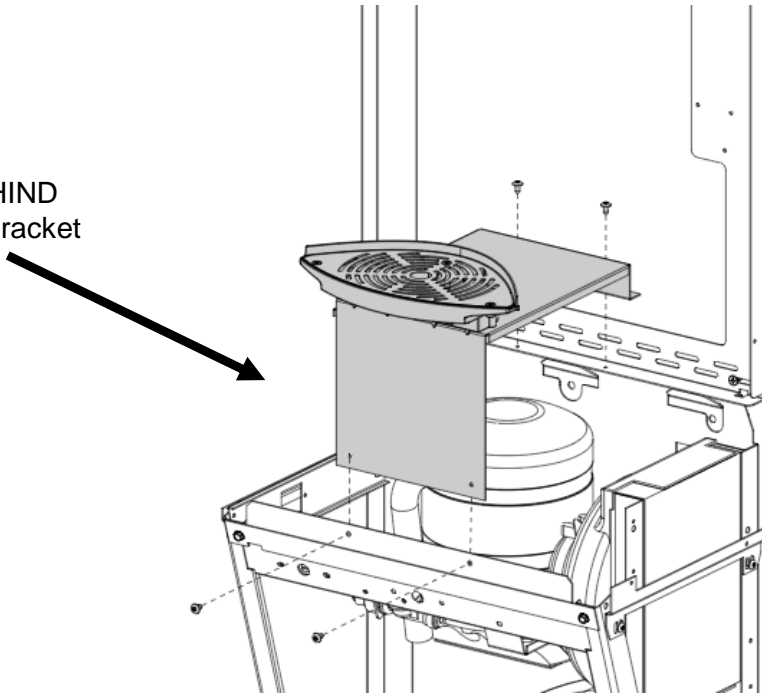

Tx4 #8, T15 Torx Screws

7. Attach the filter guard bracket with 2x, #8 Torx screws to the frame and drip tray support bracket. This bracket helps to prevent the filter cartridge from falling into the cooler unit below during installation or replacement.

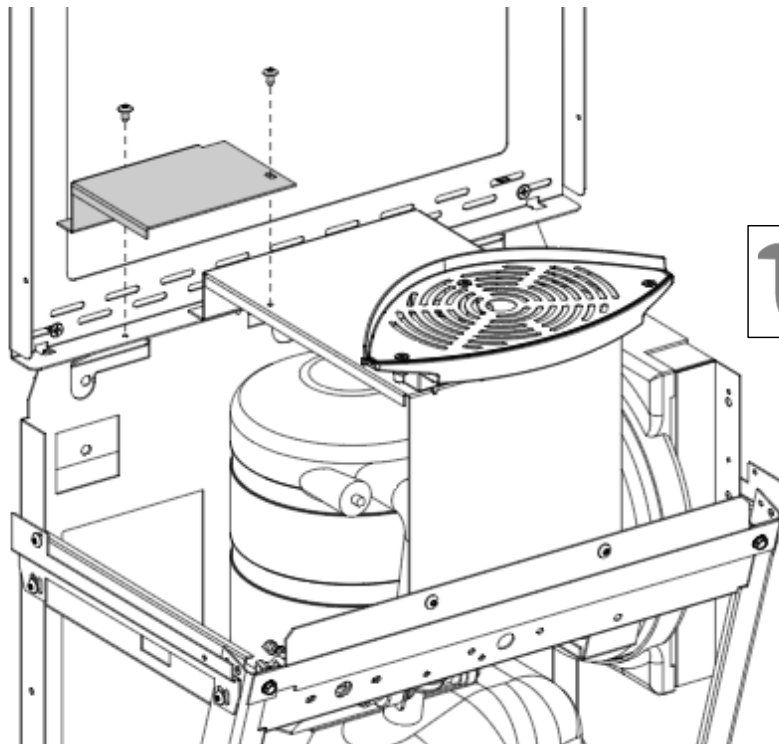

Tx2 #8, T15 Torx Screws

Section 6: Installation

8. Insert VersaFilter III Filter Head Inlet Line into water source (Fig. 8A). Install VersaFilter III Filter Cartridge to Filter Head Assembly. See instructions on filter cartridge for Installation Instructions and for Filter Flushing Instructions. Direct Remedi Filter Head Outlet Tube to a container to collect water for flushing the filters. Turn ON water supply. Flush till water is clear. When flushing is complete, turn OFF the water and insert Remedi Filter Head Outlet Tube into elbow fitting (provided) (Fig. 8B).

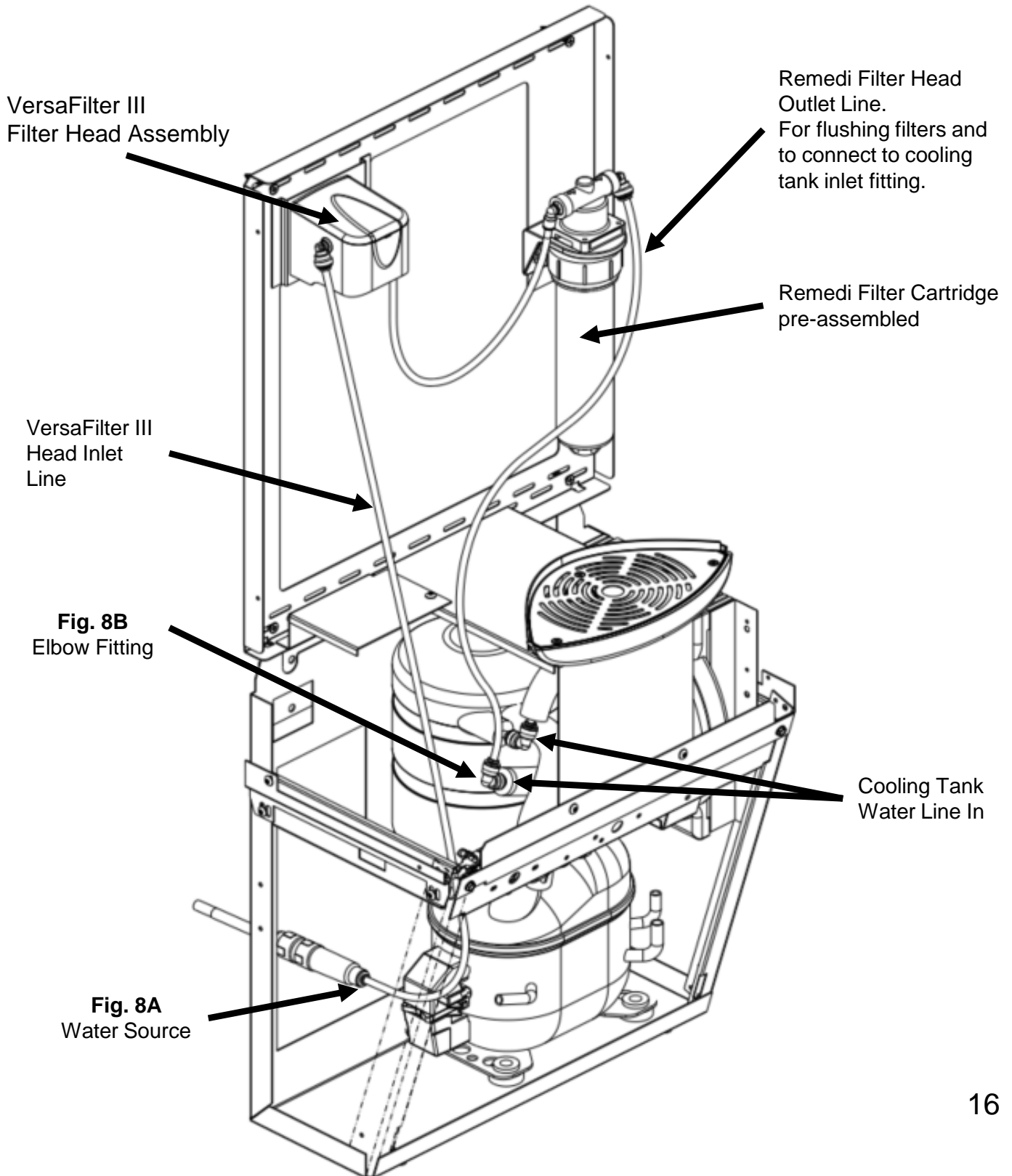

Section 6: Installation

- Attach one of the drain elbows to the drip tray stem. Insert the drainpipe provided into the elbow and then attach another elbow onto the pipe. Use the remaining drainpipe and connect the drip tray drainage system to the installed P-trap.

NOTE: Drainpipes will need to be positioned and cut to length as needed.

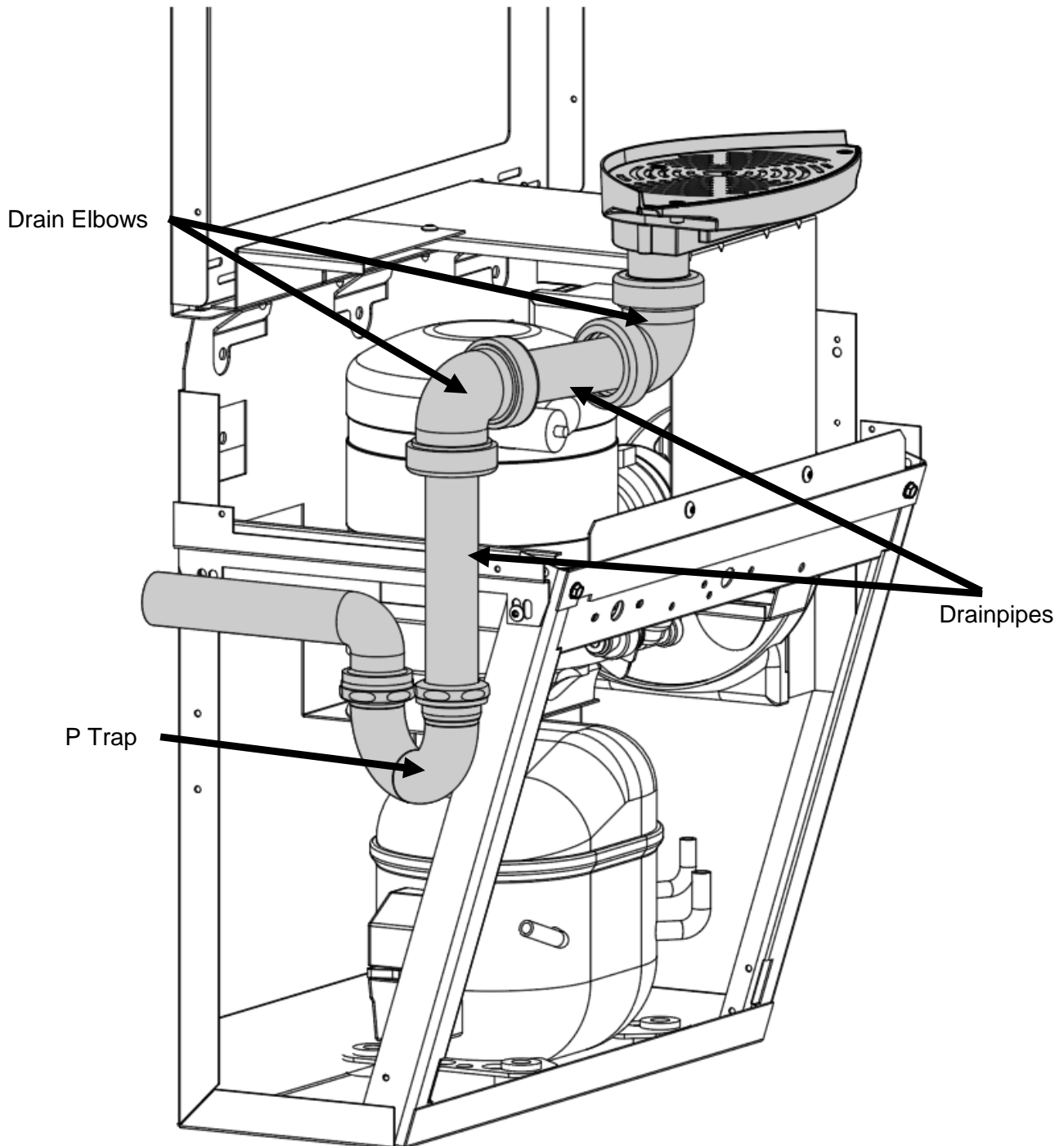

Section 6: Installation

10. Assemble unit wrapper to the installed frame. Rest the alcove on the drip tray and ensure the wrapper walls rest OUTSIDE of the frame and side brackets.

NOTE: The drip tray will hold the weight of the wrapper but it is recommended to keep a hold on the unit during installation for safety.

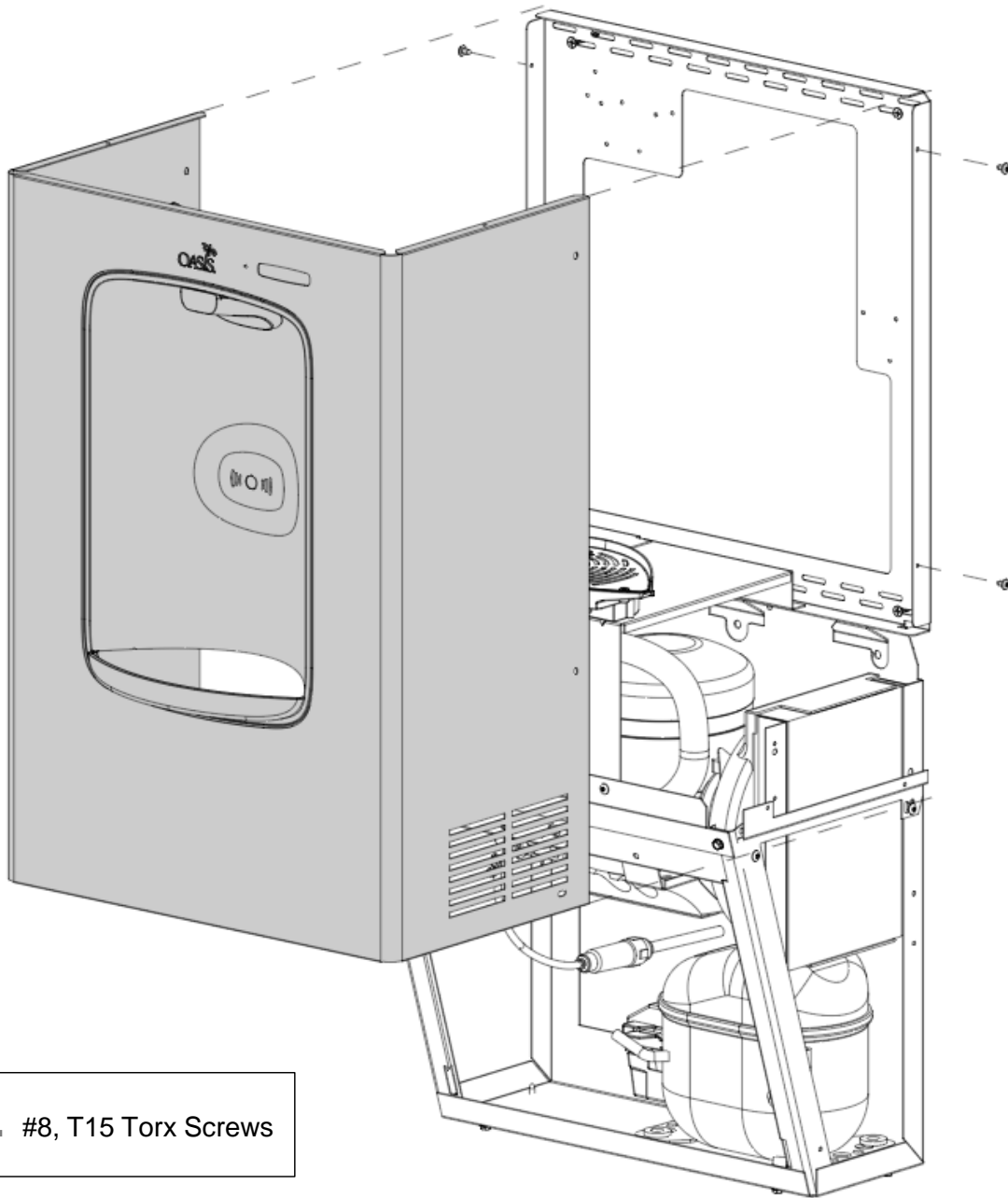

Tx4 #8, T15 Torx Screws

Section 6: Installation

11. If the outer edge of the drip tray is not properly aligned, loosen the screws on the back of the drip tray support bracket and slide the bracket forward or backward as needed. Then retighten the screws.

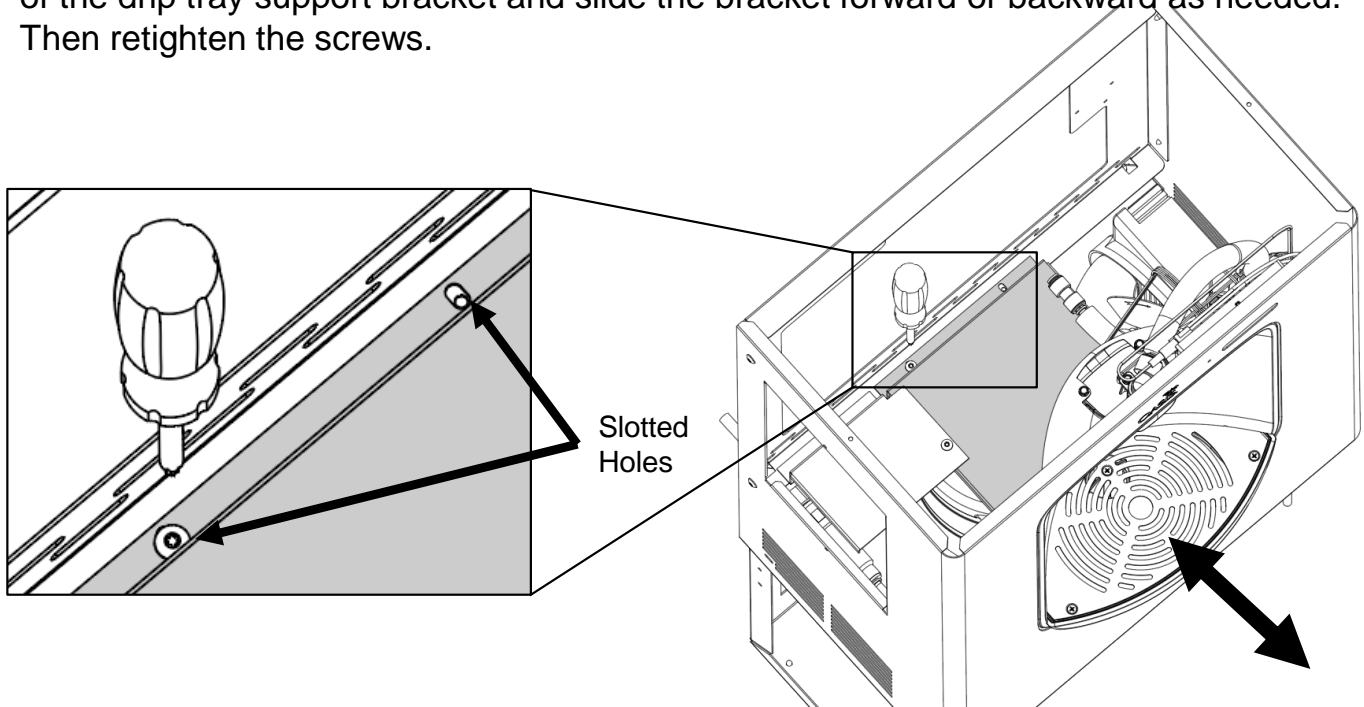

12. Once the wrapper has been installed, loosen the side bracket mounting screws until the bracket can be slid up and down. Adjust the bracket until the mounting hole screws through the slot and then drive in one of the #8 Torx screws and then tighten the two #10 mounting screws.

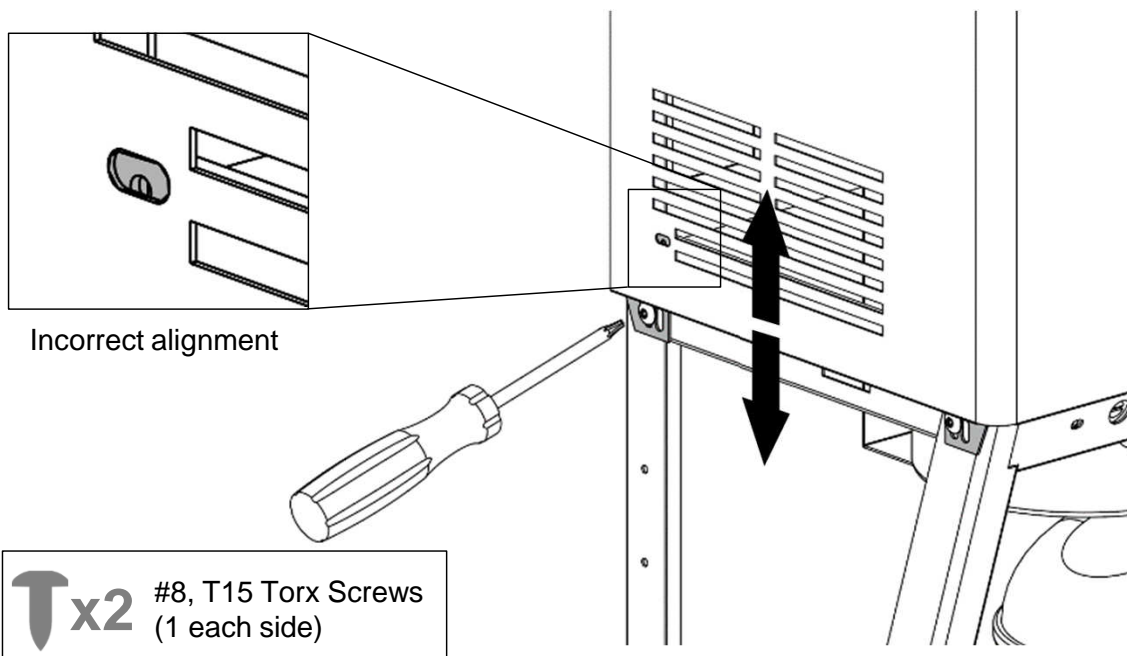

Section 6: Installation

13. Attach the ¼" union fitting to the Cooling Tank Water Outlet Line Out (Fig 13A).

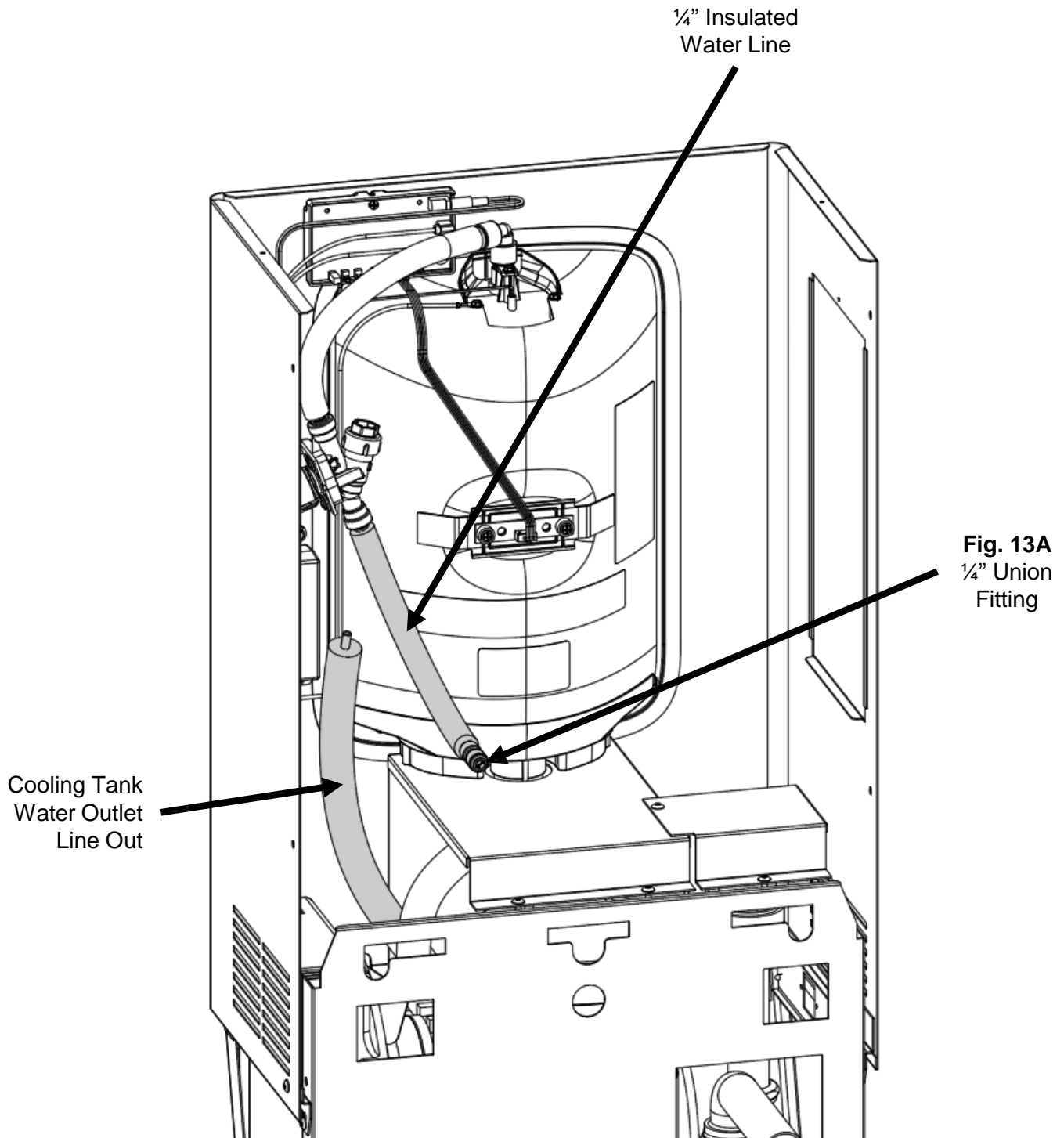

Section 6: Installation

14. Guide the power cord down to the lower portion of the cooler. Ensure that the power cord does not become entangled with other components and ensure that the IEC connector is firmly installed into the power brick.

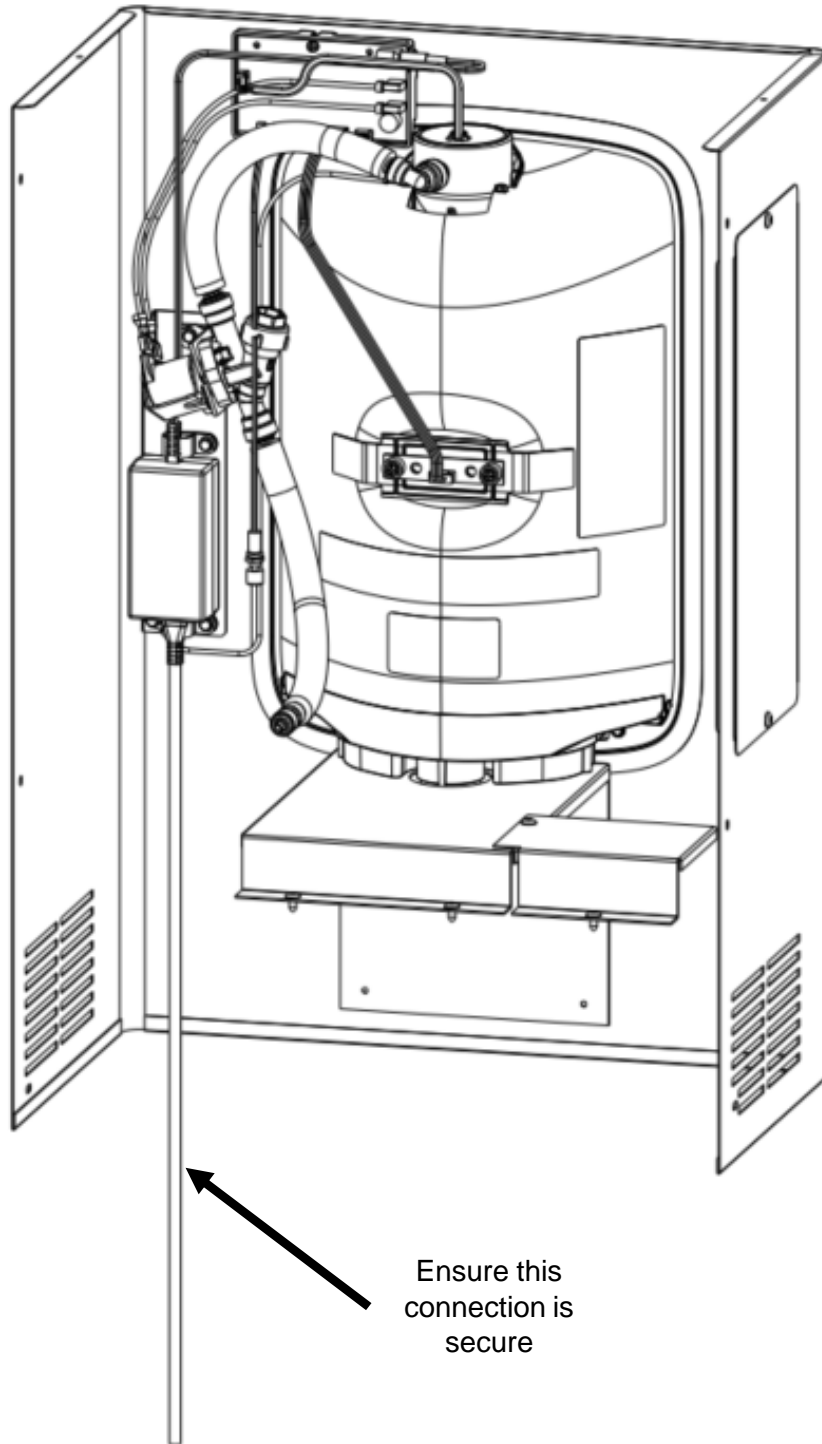

Section 6: Installation

15. Install the provided strain relief P-Clip to the power cord roughly 36" from the grounded plug. Attach it to the back side flange of the fountain frame with a #8 Torx screw. **(Figure 15a)**
16. Attach the ring terminal to the ground screw on the left side of the fountain strut through the lower flared hole using the provided #8 thread cutting hex Screw. **(Fig 16a). Do not remove/alter the original ground.**
17. Finish by plugging in the grounded plug into the duplex socket.

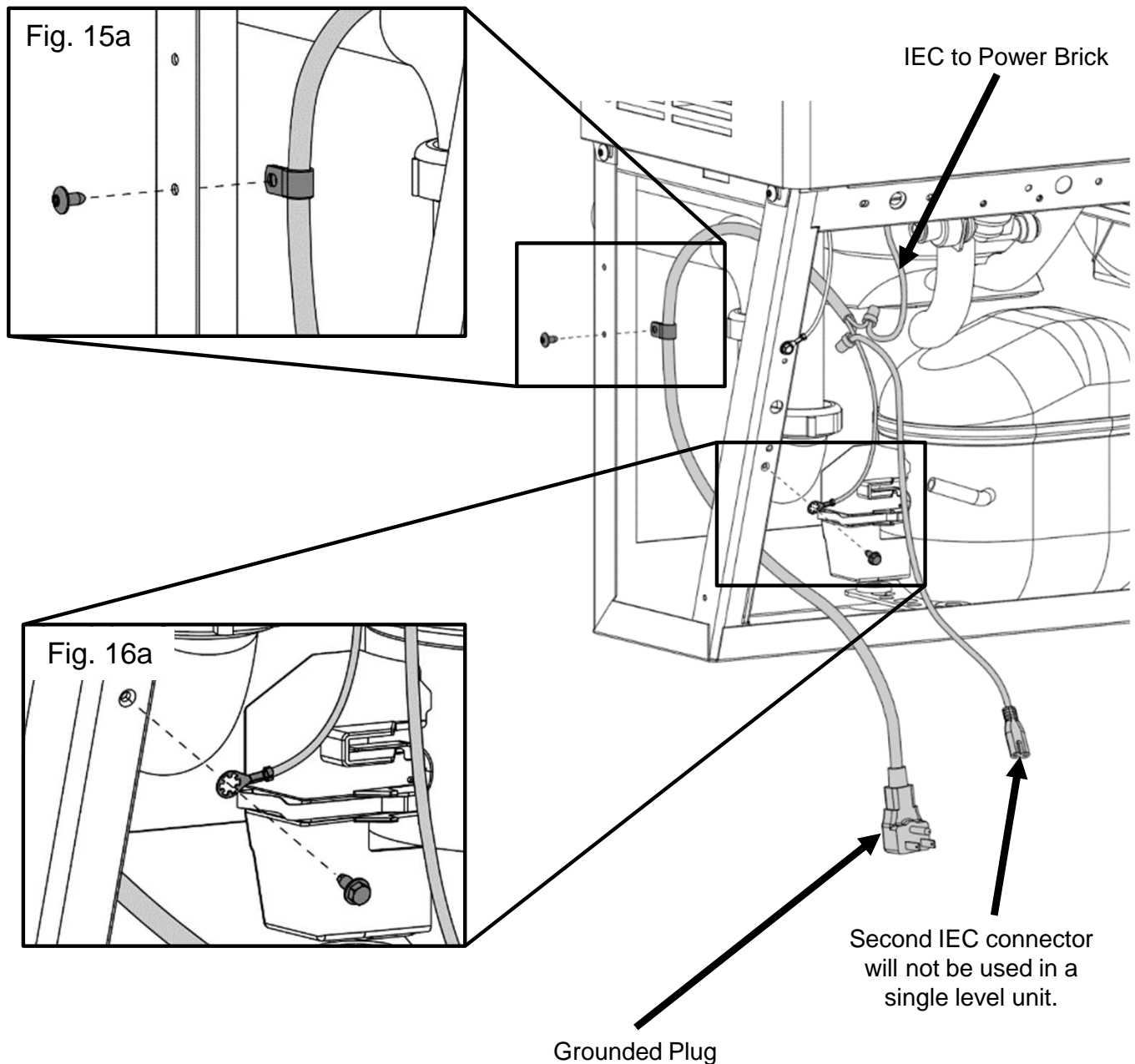

Section 6: Installation

18. IMPORTANT INSTRUCTIONS FOR QUASAR MODELS:

REVIEW Section 2 & 3A: QUASAR UV-C LED OPERATION before proceeding. Failure to follow Section 2 & 3A can damage the QUASAR.

19. Turn ON water supply and check for leaks. Ensure nothing is obstructing the fan blade.
20. Plug bottle filler cord into the electrical outlet. The bottle filler will auto-calibrate and be set up specifically for that installation. Refer to the "SET-UP GUIDE FOR OASIS HANDS-FREE QUASAR BOTTLE FILLER ELECTRONICS" program guide for further programming. Access programming Pushbutton through top of Bottle Filler.
21. Place bottle in the bottle filler alcove to dispense water. Activate sensor for approximately 15 seconds to purge air out of the system. Remove bottle for 5 seconds to allow LED to cool. Repeat until a steady stream of water dispenses.
22. If everything works correctly, Install the cabinet top panel, filter access panel and Elkay cooler wrapper.

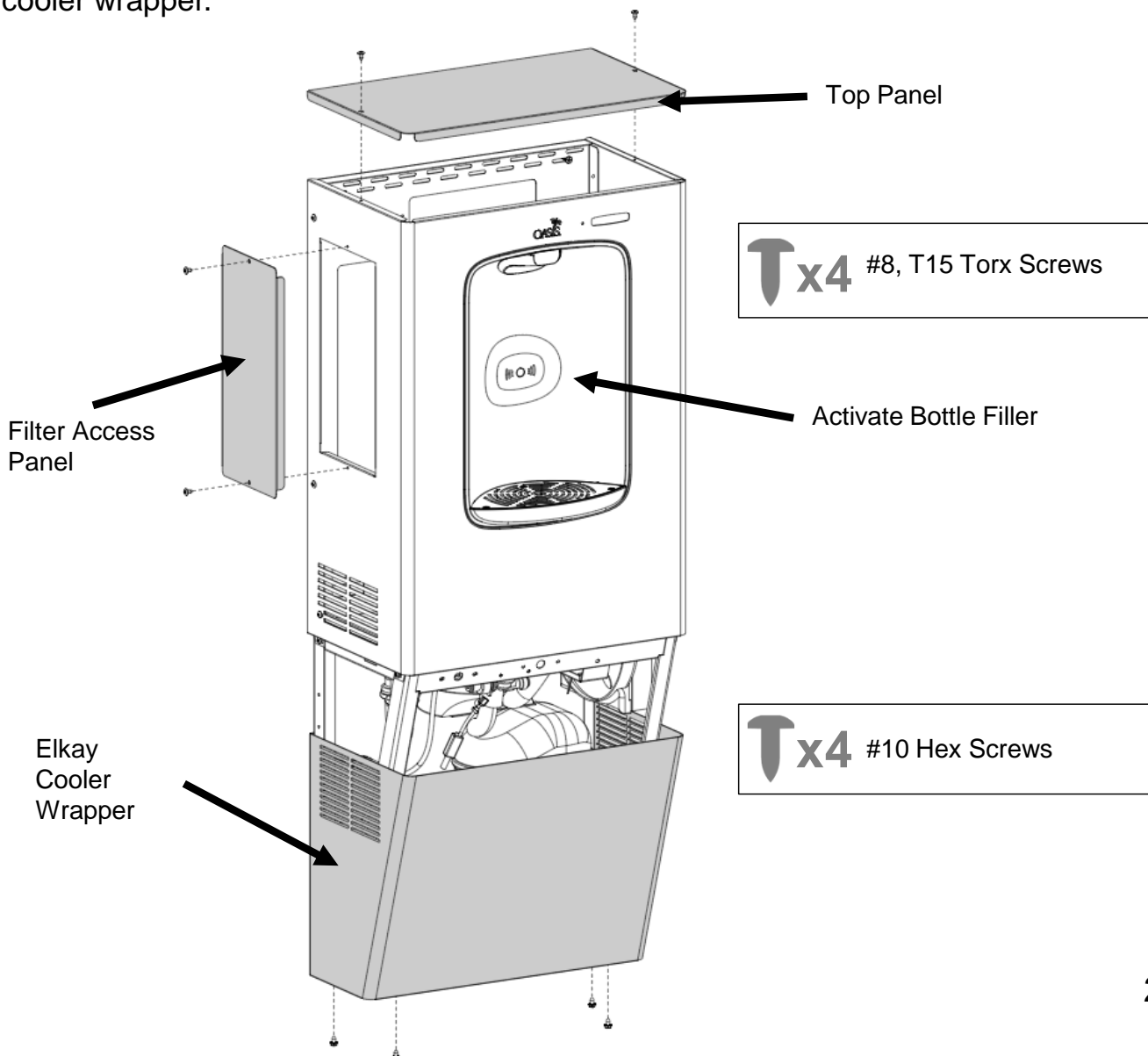

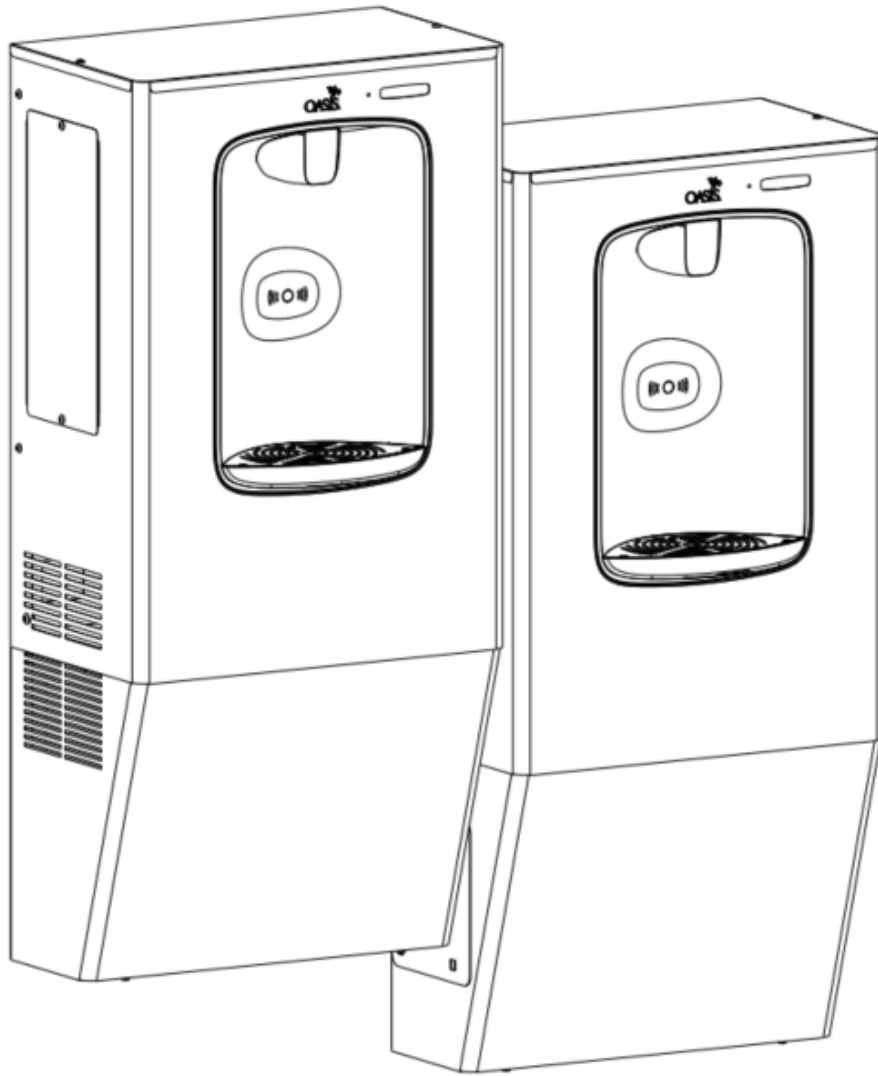

SPLIT LEVEL INSTALLATION

- **Assembly of Split Level NNF2EBQEZ Cabinet**
- **Wiring**
- **Plumbing**

Section 7: Rough In Drawing

NNF2EBQEZ Split Level: Left Side or Right-Side High

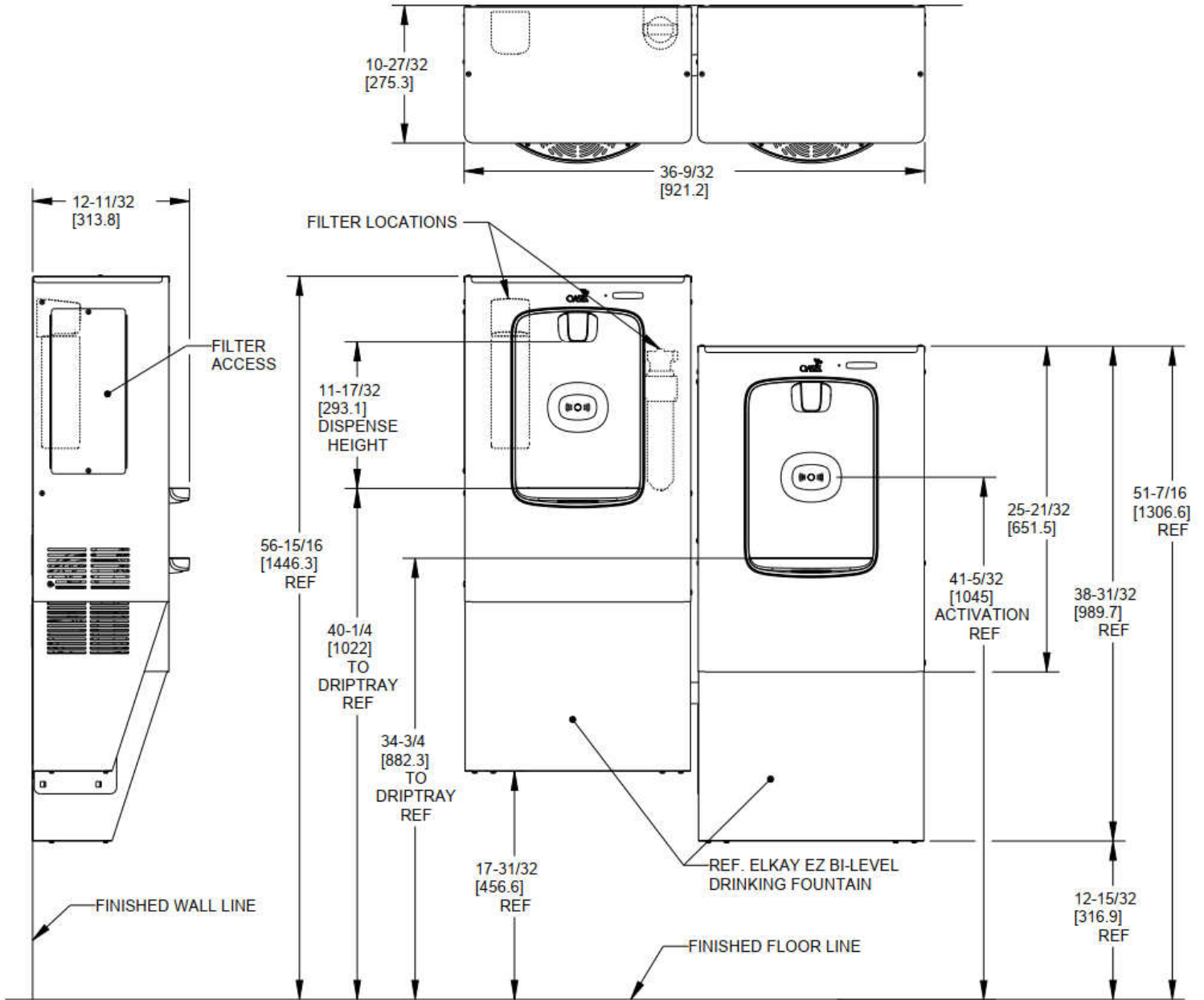

NOTES:

1. ALL DIMENSIONS ARE IN INCHES.
DIMENSIONS IN BRACKETS [] ARE MILLIMETERS.

Section 8: Split Level Preparation

1. Remove the fountain wrappers and noses from each unit as shown on **pages 7-8** to prepare the units for installation. Unplug BOTH units and shut off their water source.

Cover any bare terminals. Refer to **page 9**.

2. Begin split level assembly by disconnecting and removing any drainpipes except for the p-trap and disconnecting the water lines between the fountain units. **Ensure water to the units has been turned off.**
3. Since the split level fountain cold tank is already pressurized, disconnect all water lines from the solenoid valves in both the refrigerated and dummy unit. Do not discard any water tubing.

ORIGINAL CONFIGURATION

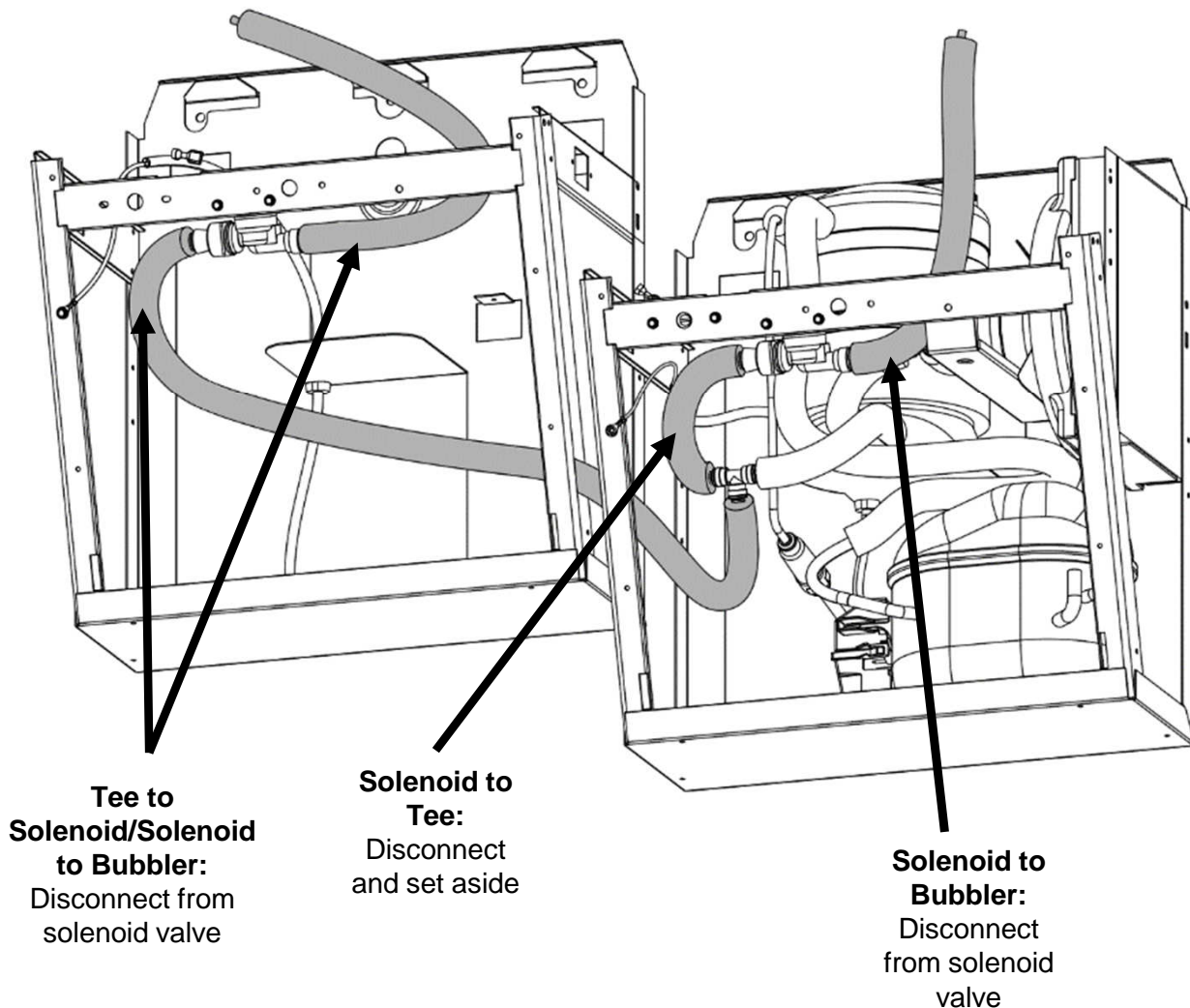

Section 8: Split Level Preparation

4. The final result should have the water line from the cold tank water outlet connect to the tee and split off to the dummy unit and up to the top of the refrigerated unit.

NNF2EBQEZ CONFIGURATION

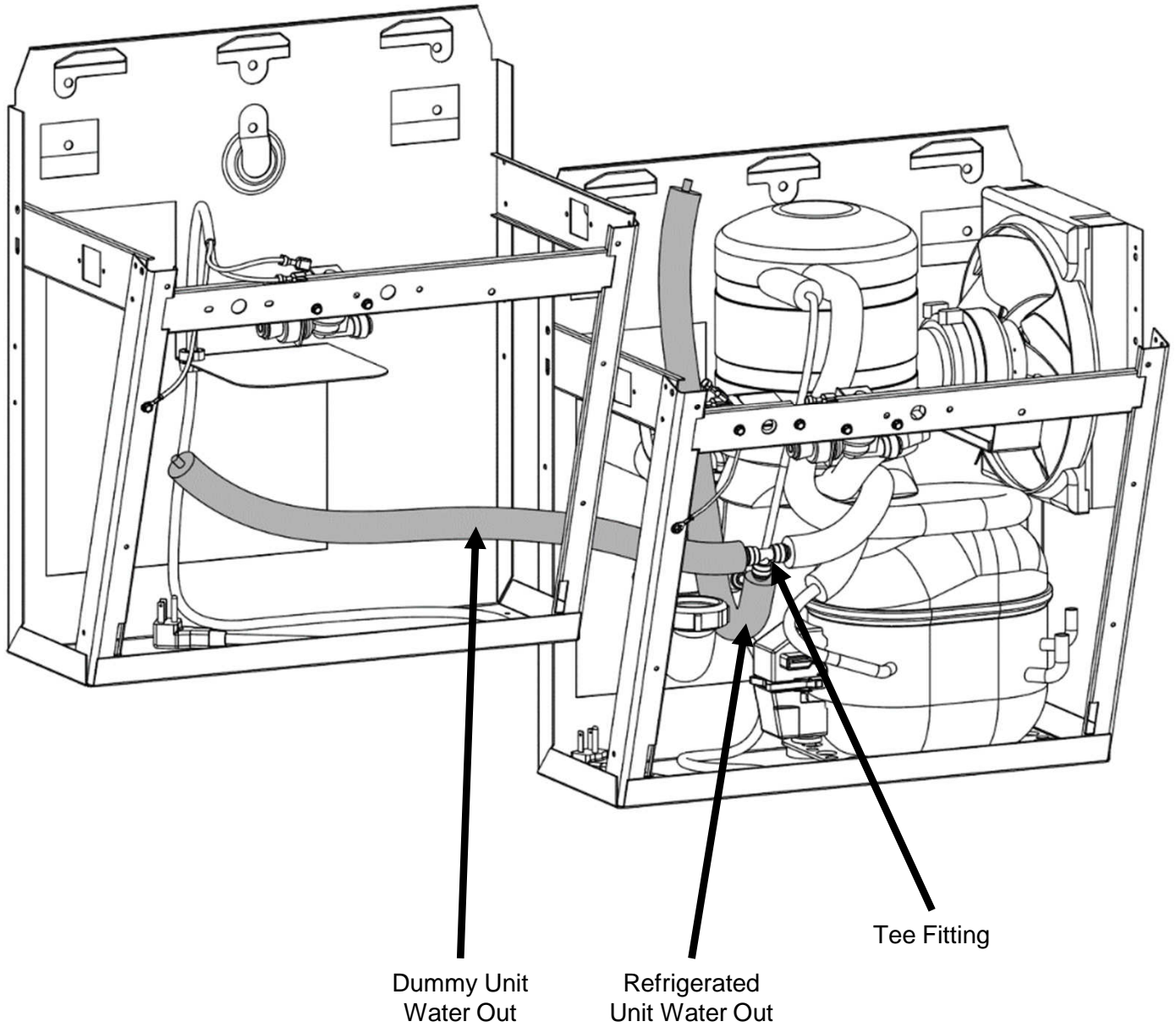

Section 8: Split Level Preparation

5. Set the frame from the second NNF2EBQEZ kit onto the top of the dummy unit frame and mark the location for each anchor. **PRE-DRILL** the holes for your chosen anchors (not included).

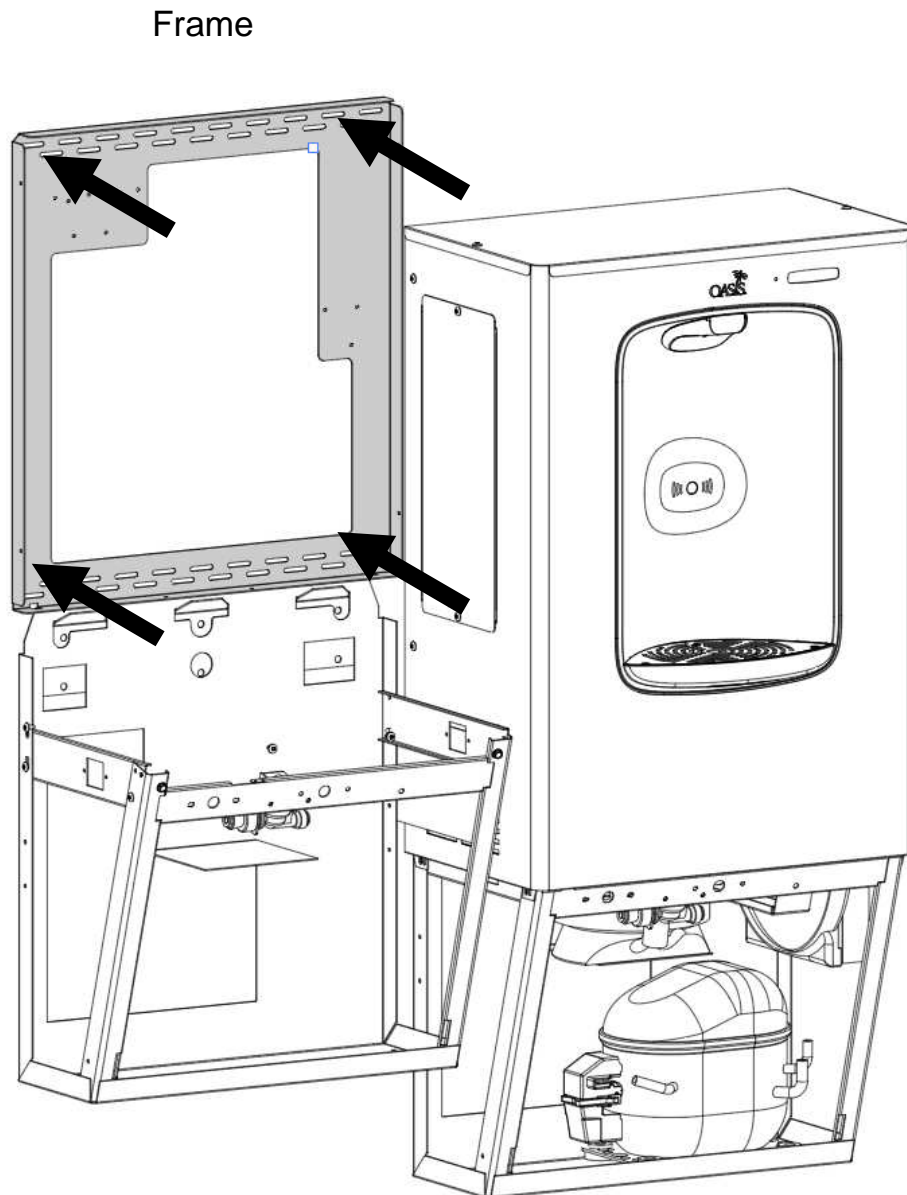

Section 9: Installation

6. Remove the dummy unit from the wall hanger and place it out of the way. Completely assemble a NNF2EBQEZ to the **refrigerated side first (Refer to pages 12-20)**.

Follow all steps on page 17 with the provided drain supplies, but do not connect to the P-trap or other existing pipes.

Note: The fountain frame may be secured by two anchors at the lower corners. Remove the anchors and set aside until the unit is ready to be reinstalled to the wall.

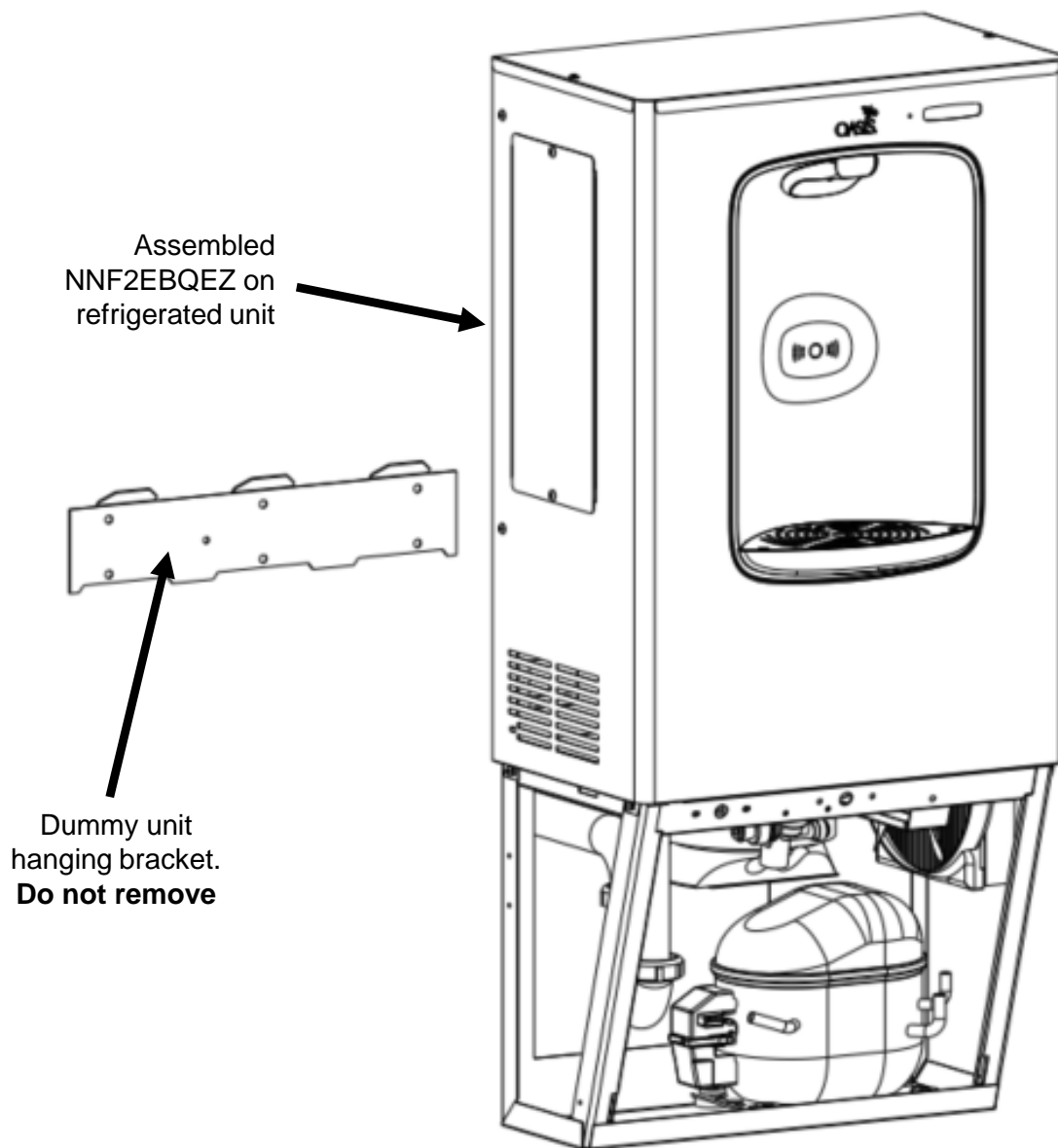

Section 9: Installation

7. Take the second NNF2EBQEZ out of the carton and prepare the unit as shown on **page 12**. Assemble the side brackets and center bracket to the dummy unit. **Refer to page 14**.
8. Lay the dummy unit on the floor and position the frame so that it sits on the top flange of the fountain frame, then assemble the drip tray assembly bracket to the unit. **Refer to page 13**. It is recommended that the filter guard bracket is not installed in this step.

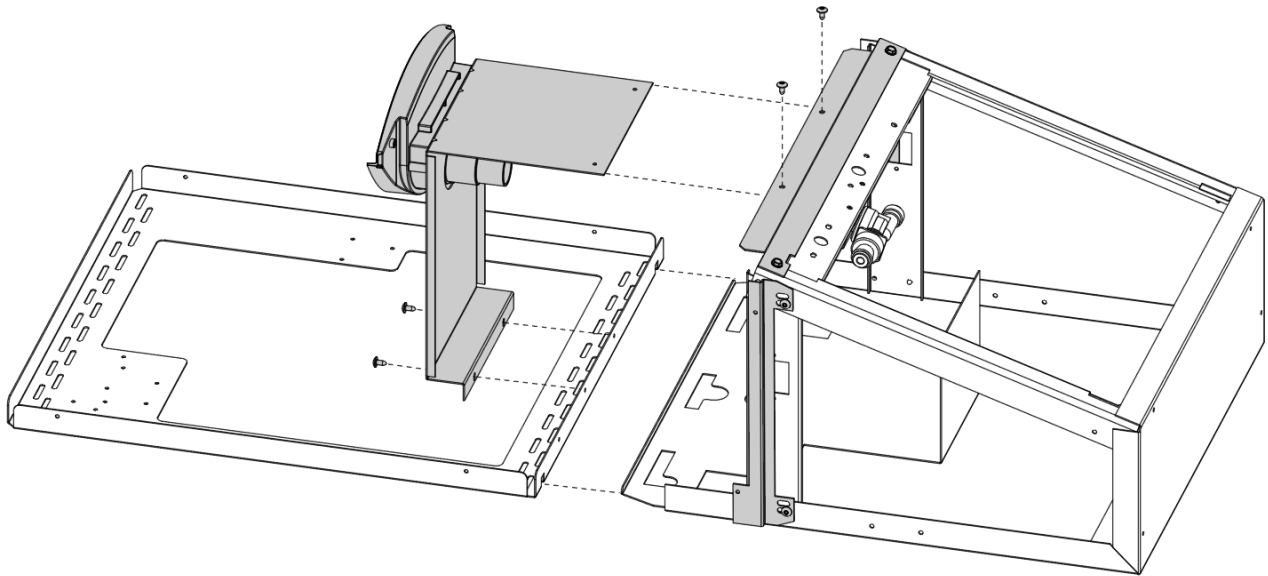

9. Assemble the provided drain elbows and short drainpipe to the drip tray drain.

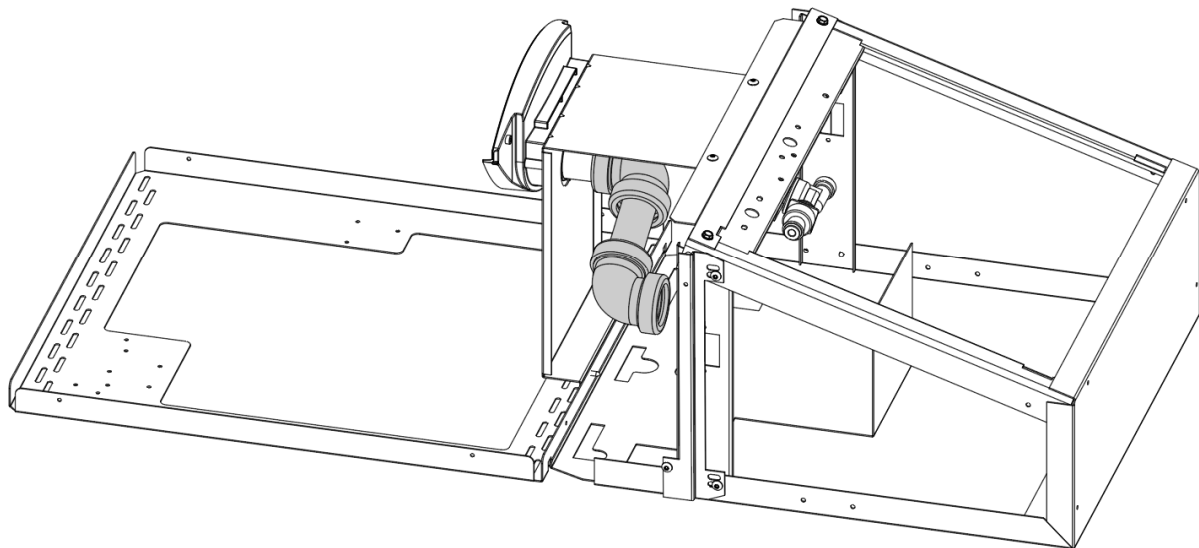

Section 9: Installation

10. Assemble the supplied P-Clip roughly 36" from the grounded plug on the supplied power cord, then secure the P-Clip to the inside surface of the horizontal strut of the fountain frame with a #8 Torx screw.

NOTE: Only one of the two power cords from the kits will be used.

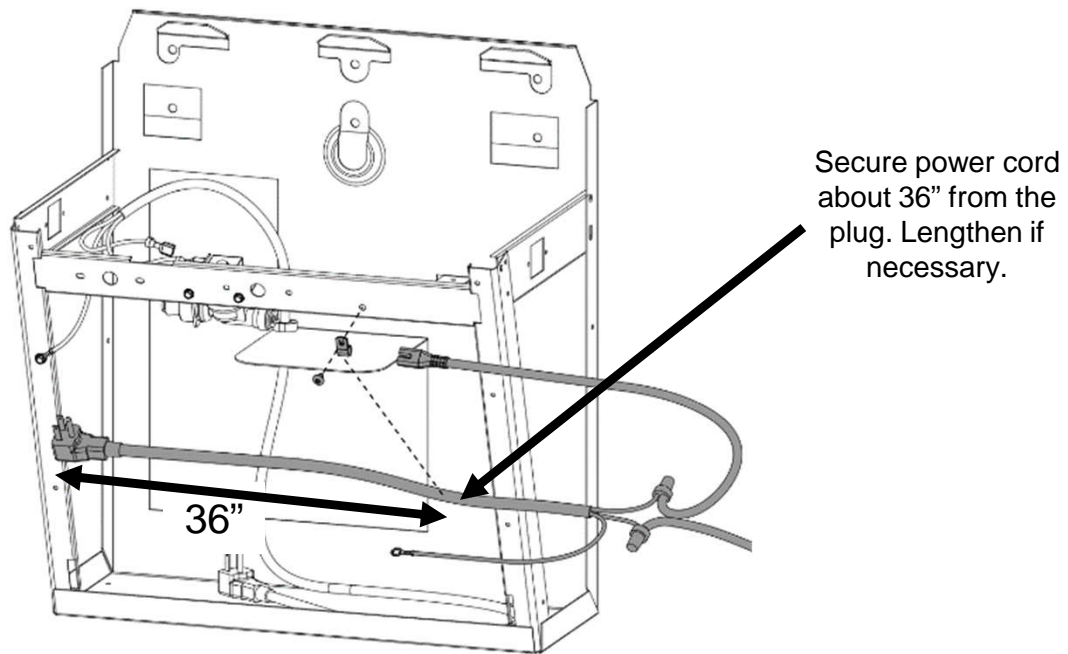

11. Install the ring terminal to the inside vertical strut of the dummy unit with the provided #8 thread cutting hex screw. Screw into one of the empty flared holes of the strut.

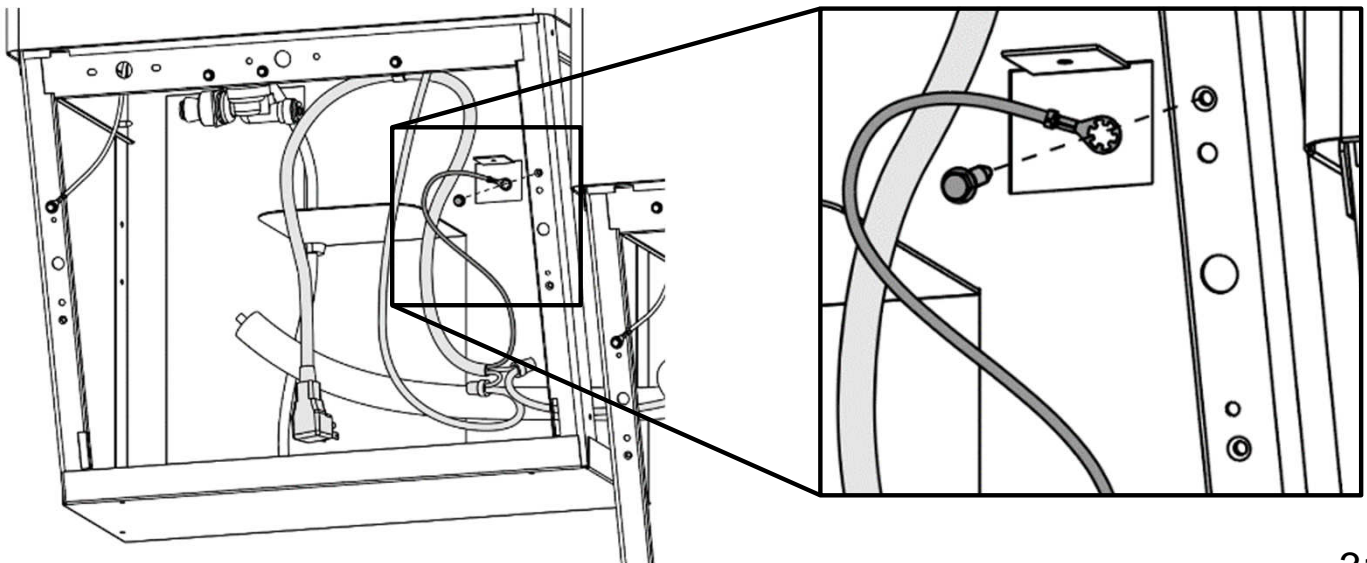

Section 9: Installation

12. Disconnect the IEC connector from the power brick located behind the alcove. Set aside but do not discard the supplied power cord. Do not remove the power brick.

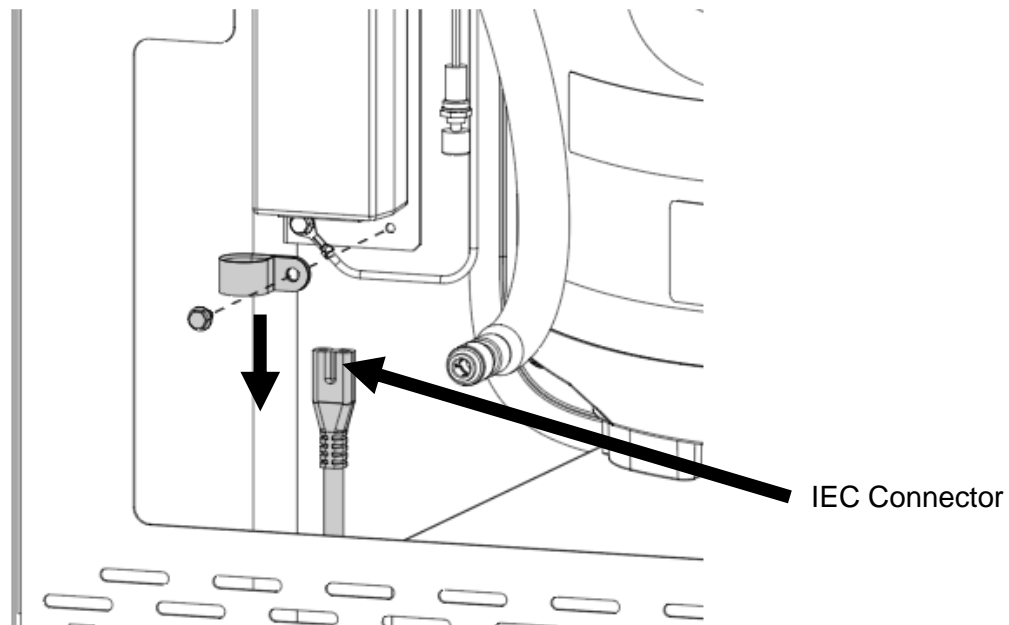

13. Secure the wrapper assembly to the unit by inserting the 6, #8 Torx screws into the frame and side brackets. **Refer to pages 18. Do not perform the steps on page 19 yet.**

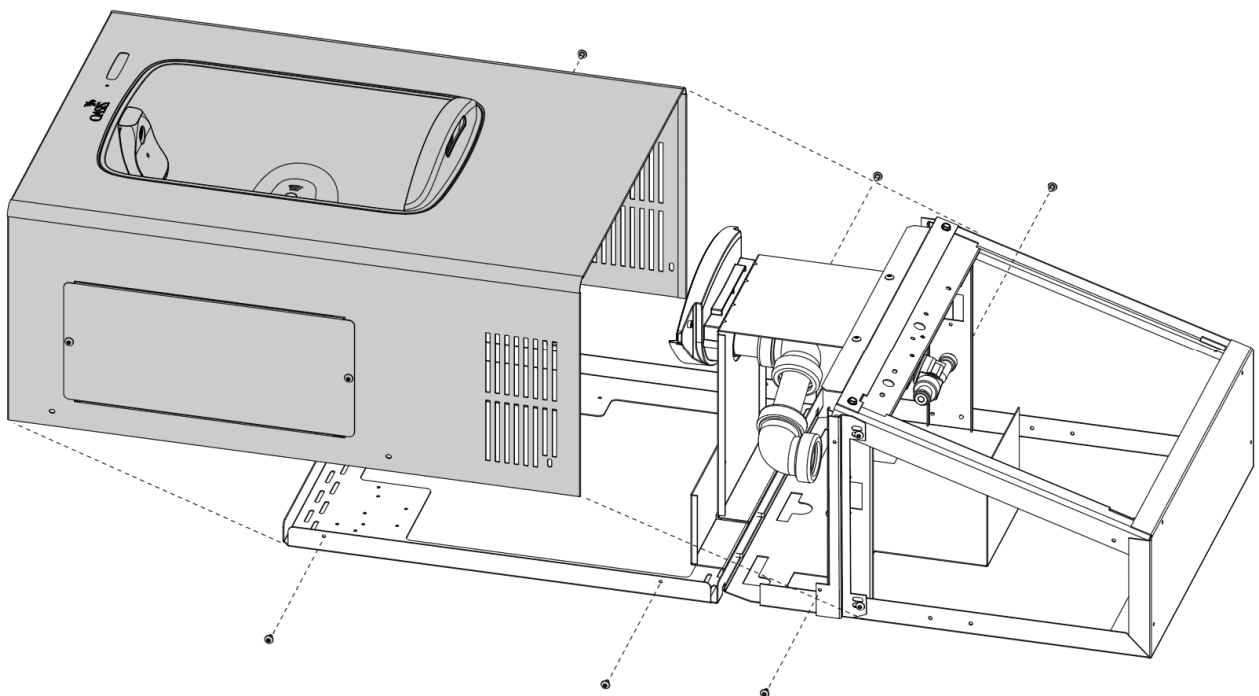

Section 9: Installation

14. Pick up the assembly by taking hold of both the fountain frame and NNF2EBQEZ cabinet, then hang the fountain on the wall hanging bracket.

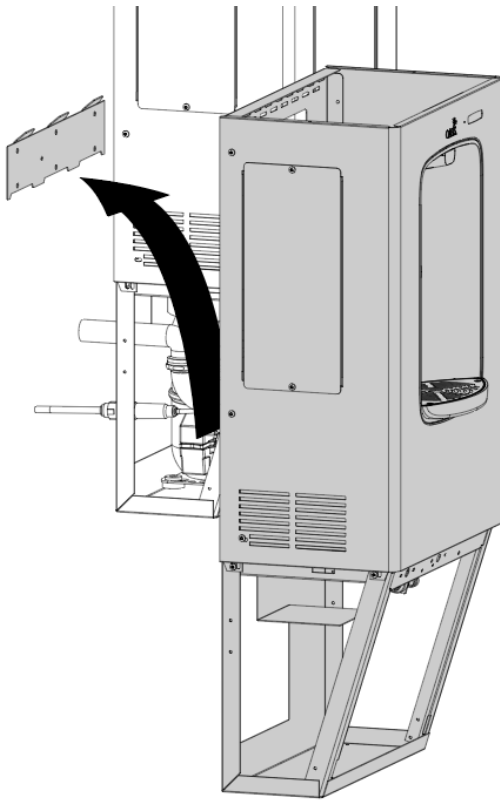

NOTE: Ensure that the NNF2EBFQZ frame sits on top of the fountain frame. Center the cabinet on the frame as shown on **page 13**. Some extra positioning may be necessary.

15. Ensure that the frame is flat against the wall and install your four chosen anchors (not supplied) into the wall to secure the unit. Ensure that the frame does not shift and is still centered, sitting on the frame of the cooler frame.

Once secured, follow **step 11** on **page 19** if necessary.

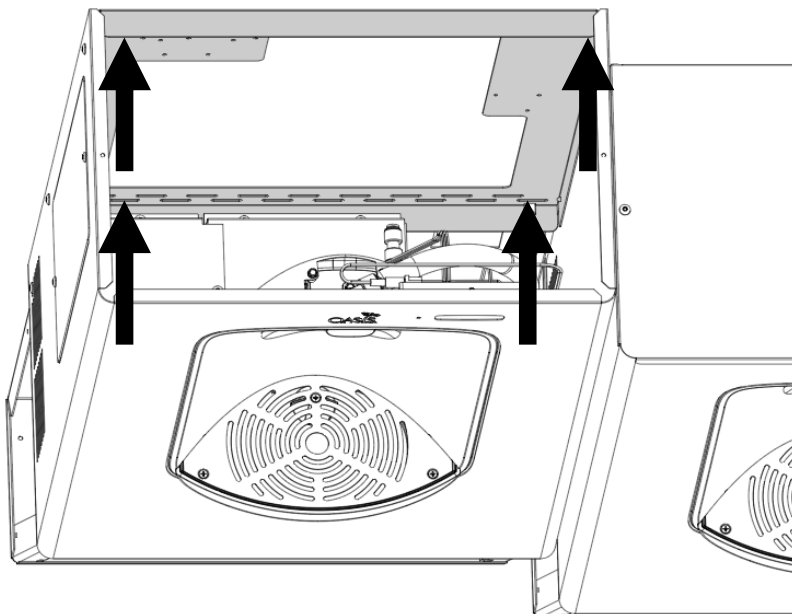

Section 9: Installation

16. After the NNF2EBQEZ has been hung, the fountain frame may not properly sit back on the wall. Loosen the side screws so that the fountain may rest against the wall, then re-tighten the side screws.

NOTE: Only one side screw will be accessible on the side facing the other fountain unit. Loosen the most outward screw to allow the unit to fall into position, then re-tighten.

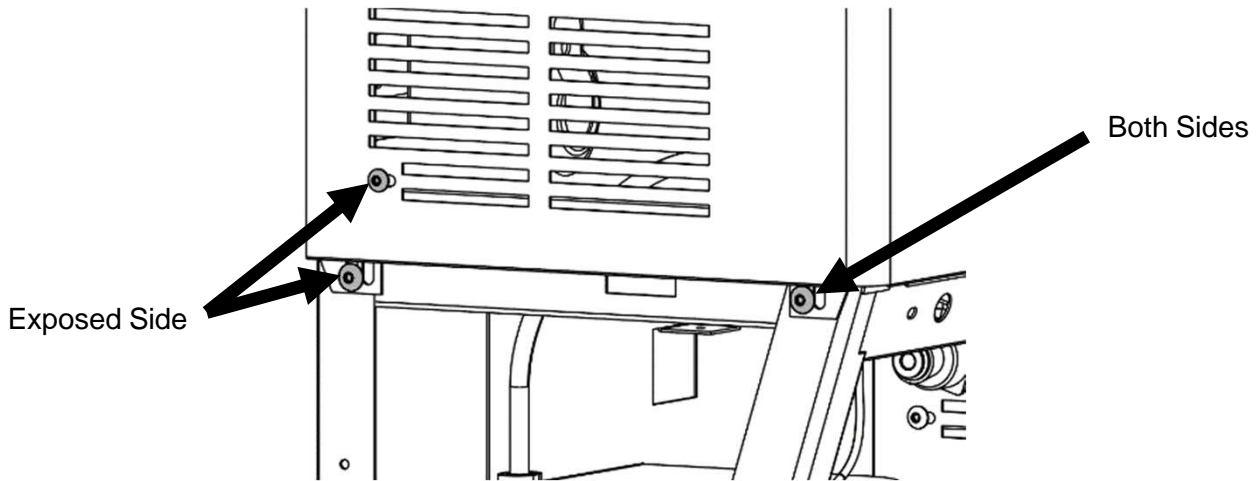

17. Install the provided long drainpipes to the elbow fittings of each unit. Next, install the Elkay drainpipes to connect the drains and then connect to the P-Trap. Cut provided pipes as needed.

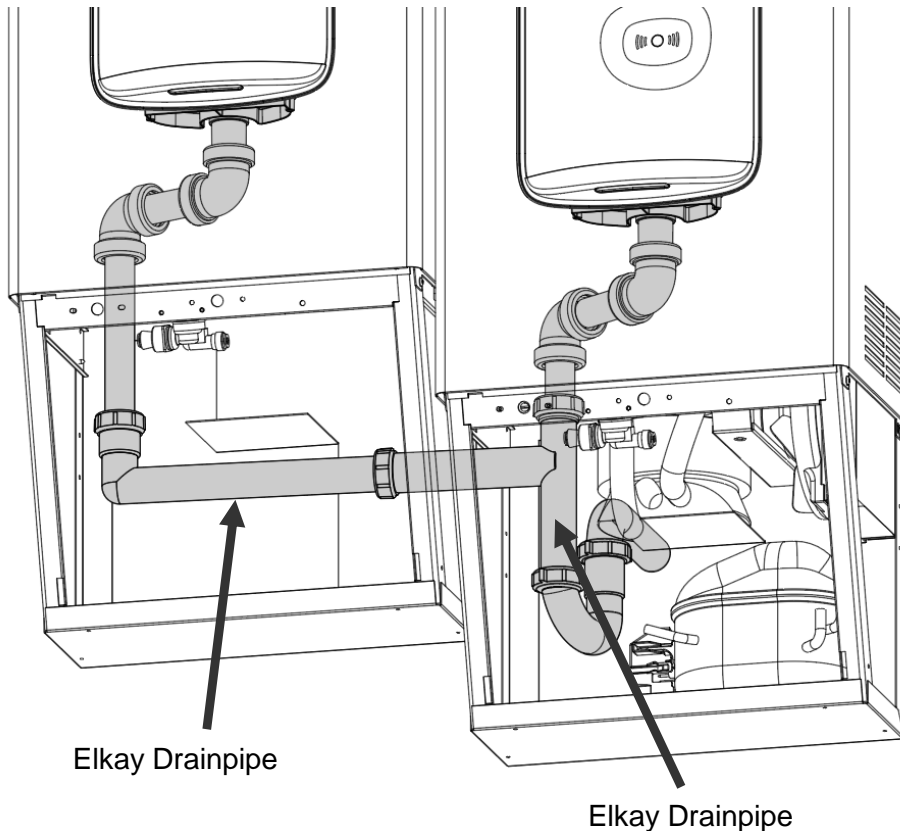

Section 9: Installation

18. Connect the provided ¼" union fittings to the water-out lines of each fountain (see **page 27**). Connect the provided ¼" water lines and sponge tubing from each kit to the fountain water out lines and install into the solenoid located on top of the alcove. Reference **page 20**.
19. On the dummy unit: Remove 1/4"OD water source line from refrigerated unit (see **page 10**). See **page 16** for flushing the filters, connecting the filter head inlet line and the outlet line to the refrigerated unit.
20. Connect each of the power bricks in each conversion kit with one of each of the two IEC connectors. Ensure that the wires will not obstruct the fan blade. **See to page 21**.
21. Refer to **page 23** for **IMPORTANT INSTRUCTIONS FOR QUASAR MODELS**. For the final flushing of each unit.

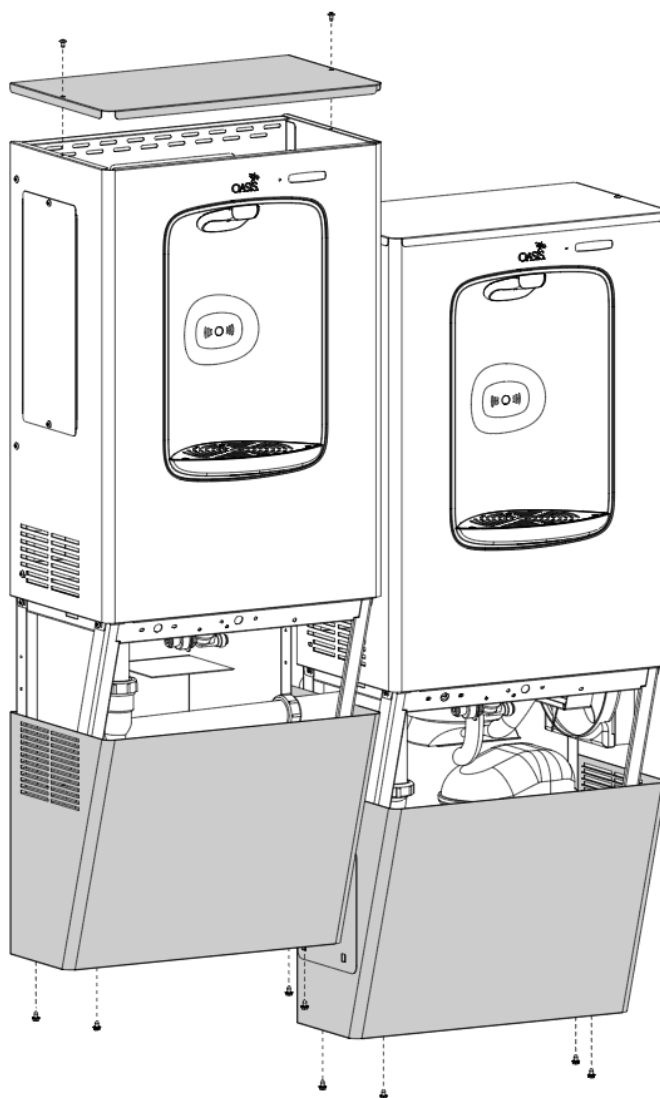

OWNER'S COPY BOTTLE FILLER 1-YEAR LIMITED WARRANTY

ONE YEAR: The Manufacturer promises the original purchaser (user) to repair or, at the Manufacturer's option, to replace any part of this bottle filler which proves to be inoperative due to a defect in material or workmanship under normal use, **for a period of one year from the date of sale.** During the one year warranty, the Manufacturer **will**, through its approved service center or factory repair department, provide labor and parts necessary to correct such inoperative condition at no charge, provided the water cooler has been installed and operated in accordance with the written instructions furnished with the water cooler.

The cost of labor required to disconnect and reconnect plumbing and electrical connections will be the responsibility of the user (owner).

GENERAL PROVISIONS AND EXCLUSIONS:

This warranty applies only within the Continental Limits of the United States of America and Canada.

This warranty does not apply and no agreement, either expressed or implied, shall be applicable if the affixed serial number is removed, defaced or obliterated.

This warranty does not apply if service of the sealed refrigeration system or parts furnished as original equipment by the Manufacturer are not obtained from an approved service center or the factory.

This warranty does not apply to any water components that become inoperative due to liming conditions.

This warranty does not apply to any bottle filler or components that become inoperable because of a failure to satisfy standards or regulations adopted by any government or agency thereof subsequent to the date of shipment from the factory.

This warranty does not cover performance, failure or damages of any part resulting from external causes such as alterations, abuse, misuse, misapplication, corrosion or acts of God.

WARNING

The warranty and the agency certifications / listings for this machine are automatically voided if this machine is altered, modified, or combined with any other machine or device. Alteration or modification of this machine may cause serious flooding and/or hazardous electrical shock or fire.

Except as set forth herein, THE MANUFACTURER MAKES NO OTHER WARRANTY, GUARANTEE, OR AGREEMENT, WHETHER EXPRESSED, IMPLIED, OR STATUTORY, INCLUDING ANY IMPLIED WARRANTY OF MERCHANTABILITY OR FITNESS FOR A PARTICULAR PURPOSE.

The foregoing is in lieu of all other agreements, whether expressed, implied or statutory and all other obligations or liabilities of the Manufacturer. The Manufacturer does not assume or authorize any person to assume any obligations of liability in connection with this product. In no event will the Manufacturer be liable for special or consequential damages or for any delay in the performance of this agreement due to causes beyond their control. Manufacturer does not accept liability on any orders shipped via carrier collect accounts non-LTL carriers, e.g. UPS, Fedex express or ground.



222 East Campus View Blvd. • Columbus, OH 43235 U.S.A.

1-800-646-2747

www.oasiscoolers.com

Installation of the NNF2EBQEZ could void the original water fountain warranty.

Model NNF2EBQEZ Chilled Bottle Filler Retrofit Kit for ELKAY EZ8 and LZ8 Water Coolers

Installation Instructions



P/N 030099-717, Rev. A, Date: 02/2024

© 2024 LVD Acquisition, LLC

Oasis, Aqua Pointe, Versacooler and VersaFiller are registered trademarks of LVD Acquisition, LLC dba Oasis International

The ELKAY trademark is registered and owned by Elkay Manufacturing Company. OASIS International is not affiliated with Elkay Manufacturing Company in any way. No OASIS International Products are associated or affiliated with, sponsored or endorsed by the Elkay Manufacturing Company.



OASIS INTERNATIONAL
222 East Campus View Blvd.
Columbus, OH 43235
614-861-1350
www.oasiscoolers.com