

User Guide

Please read this Instruction Manual before using your Water Dispenser

MAXXFILL™ PULSE

BY:



CONTACTLESS POU HOT, COLD
& ROOM TEMPERATURE WATER
DISPENSER

MODEL: P1CMPVHSK

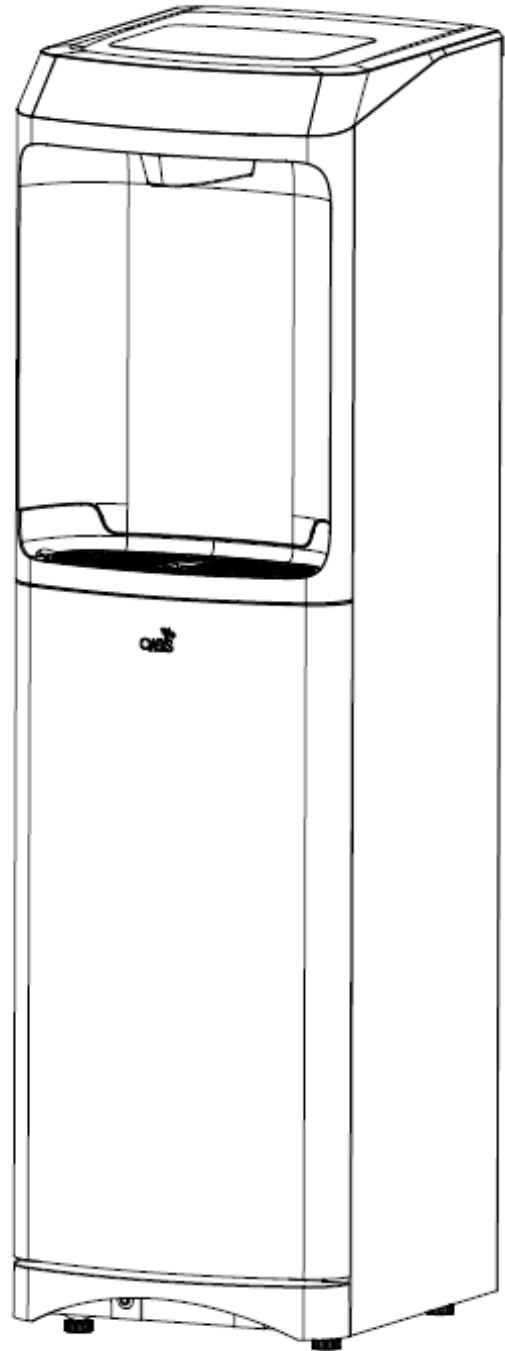

TABLE OF CONTENTS

| | |
|--------------------------|-------|
| IMPORTANT SAFEGUARDS | pg 3 |
| GROUNDING INSTRUCTIONS | pg 3 |
| TECHNICAL SPECIFICATIONS | pg 4 |
| PRODUCT DIAGRAM | pg 4 |
| INSTALLATION | pg 5 |
| OPERATION | pg 5 |
| PREPARING THE COOLER | pg 7 |
| INITIAL SET UP | pg 8 |
| ADDING FILTRATION | pg 8 |
| CLEANING AND MAINTENANCE | pg 9 |
| TROUBLESHOOTING | pg 10 |

Purchasing an Oasis MaxxFill™ Water Dispenser was a GREAT choice!

This unique design offers the benefits of:

- Safety of touch-free filling
- Easy access to unlimited, on-demand water

Please read the enclosed operating instructions carefully and retain this booklet for future reference. We have carefully engineered your water dispenser to provide years of enjoyment and trouble-free operation.

IMPORTANT SAFEGUARDS

- Do not place anything on top of the dispenser due to risk of accidental activation of water sensor
- Do not approach within 24 in (60 cm) of the device while wearing a Hi-Vis safety vest due to risk of accidental activation of water sensor
- This dispenser is equipped with a grounded power cord plug for your safety.
- Do not operate this (or any other appliance) with a damaged power cord. Be sure that the plug is fully inserted into the GFCI outlet and that no other appliance is plugged into the same outlet.
- Do not run the power cord under carpeting or other heat insulators, and do not cover it. Avoid laying the cord in high traffic areas, and never submerge it in water.
- Do not use an extension cord as it may overheat, increasing the risk of fire.
- If the supply cord is damaged, contact Oasis or a qualified electrician to replace it before plugging it in.
- Never turn the dispenser upside down. If the dispenser has been resting on its side for a long period of time, place the unit in the upright position for approximately 12 hours before using.
- Never allow children to dispense hot water without proper and direct supervision.
- Always connect the dispenser to a known and microbiologically-safe water source.
- Keep your dispenser in a dry place away from direct sunlight.
- Do not use this dispenser outdoors.
- Never put anything flammable close to the dispenser.
- Leave a minimum clearance of 6 in (15 cm) in back and on both sides of the dispenser for proper ventilation.
- Always install your dispenser on a level floor.
- Wait 5 minutes before restarting the dispenser after turning it off.
- Always unplug the dispenser before servicing.

GROUNDING INSTRUCTIONS

- To provide additional protection from the risk of shock, this dispenser **MUST** be connected to a ground fault circuit interrupter (GFCI) outlet at all times. Use of an extension cord will void any warranties.
- This appliance must be grounded. Improper use of the grounding plug can result in a risk of electric shock, causing serious injury and possibly death.
- This appliance is equipped with a power cord having a grounding wire with a grounding plug and must be connected into a properly-grounded, polarized outlet.
- Consult a qualified electrician if the grounding instructions are not completely understood, or if doubt exists as to whether the appliance is properly grounded. If the wall outlet is a standard, 2-prong outlet, it is your personal responsibility and obligation to have it replaced with a properly-grounded, 3-prong wall outlet.
- Do not under any circumstances cut or remove the third (ground) prong from the power cord plug.

- Do not use an adapter plug with this appliance.

TECHNICAL SPECIFICATIONS

| | | | |
|------------------------------|-------------|------------------------------|-------------------|
| RATED VOLTAGE | 115V - 60Hz | HOT WATER/HR | 1.07 GAL (4.05 L) |
| HEATING POWER | 500W | COLD WATER/HR | 1.4 GAL (5.3 L) |
| COOLING POWER/CURRENT | 95W/1.2A | HOT WATER TEMP. RANGE | 165°F - 197°F |
| COOLANT | R134a 43g | | |

PRODUCT DIAGRAM

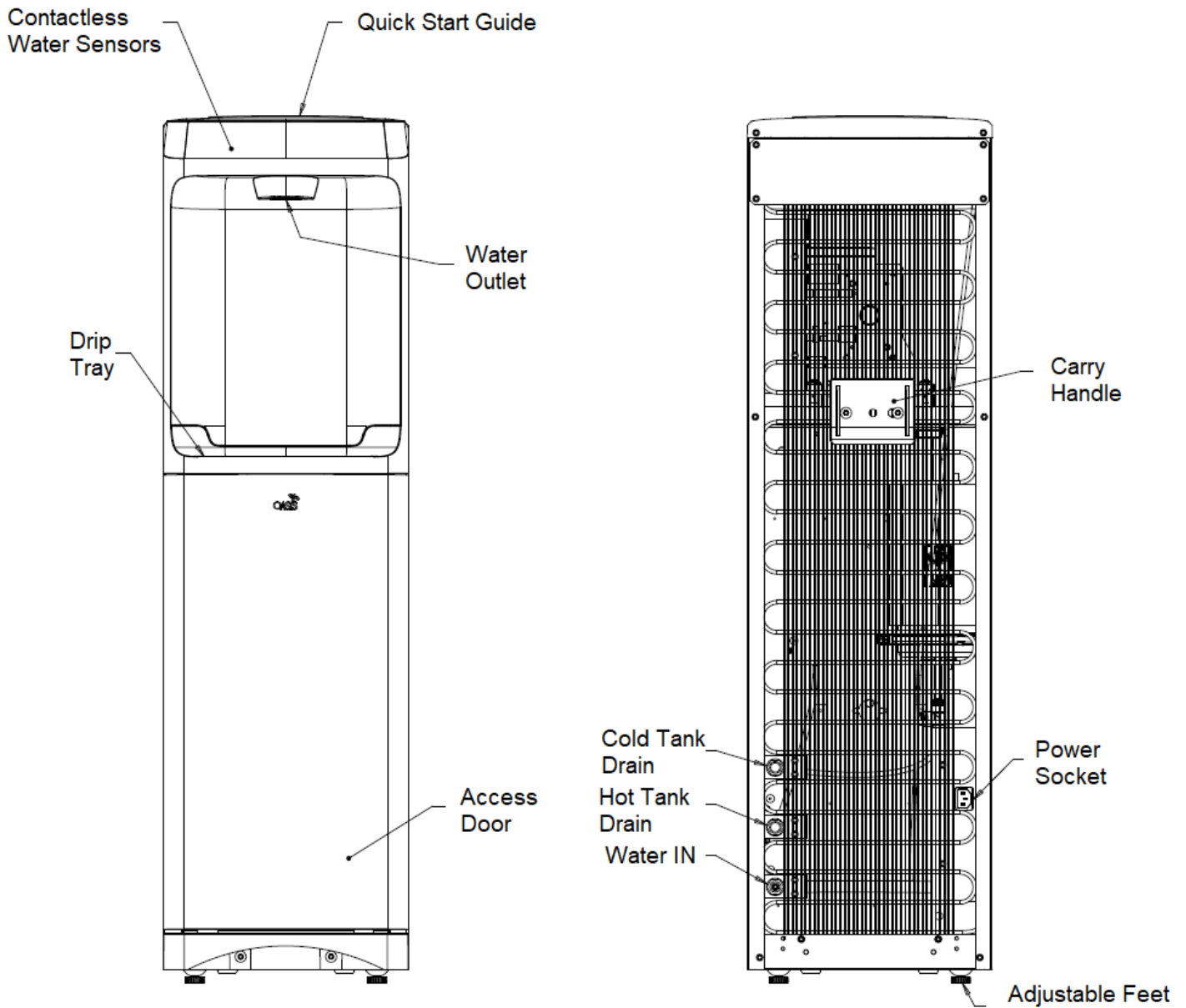

INSTALLATION

1. After unpacking, wipe dispenser with soft cloth.
2. Place the dispenser on a hard, flat surface, making certain it is level. The dispenser should not be placed near direct sunlight or any other source of heat.
3. It is best to place the dispenser in an area with good air circulation. Make sure there is at least 6 in (15cm) of clearance in back and on both sides of the dispenser for proper ventilation.

WARNING: The hot and cold tank drain plugs on the back of the dispenser may loosen during shipping. Securely tighten the drain plug before starting the dispenser. A loose drain plug may leak, causing floor damage.

OPERATION

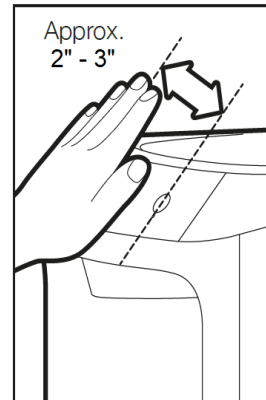
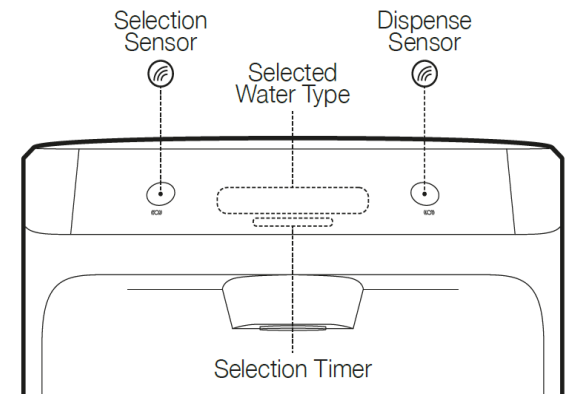

- CONTROL INTERFACE -

- CONTACTLESS SENSOR -

DISPENSING WATER (COLD & ROOM TEMPERATURE)

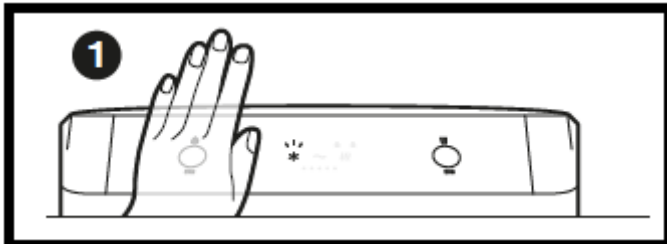

1. Hold your hand above the Selection Sensor

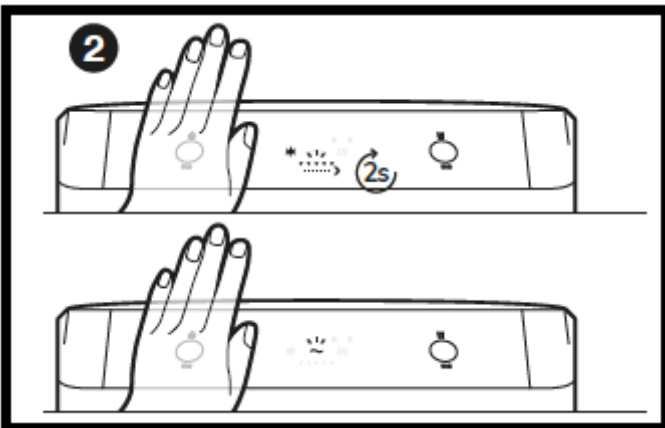

2. Water type will change every 2 seconds while you keep your hand over the Selection Sensor

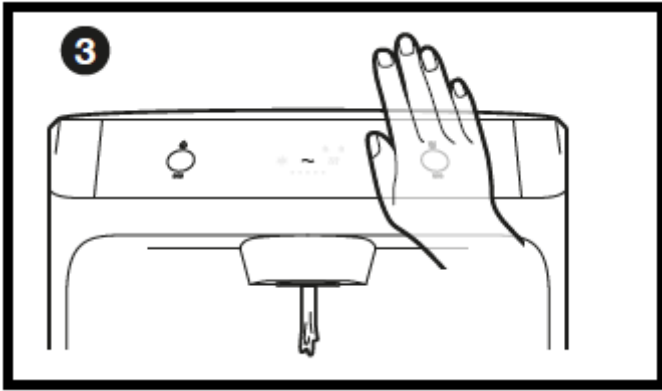

3. Remove your hand when desired water type is selected. Then hold your hand over the Dispense Sensor to dispense water

DISPENSING HOT WATER

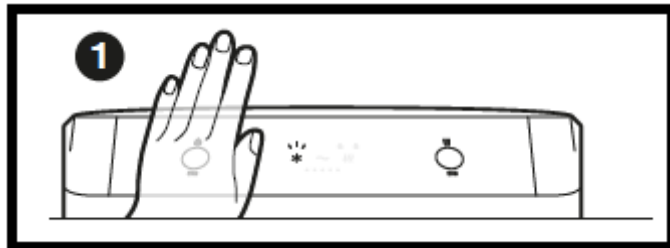

1. Hold your hand above the Selection Sensor until the hot water icon illuminates

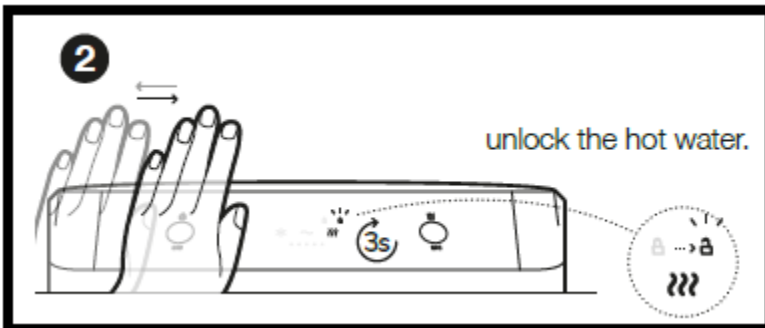

2. Unlock the hot water - remove your hand from the Selection Sensor. Then, within 3 seconds, place your hand back over the Selection Sensor until the Unlock symbol illuminates

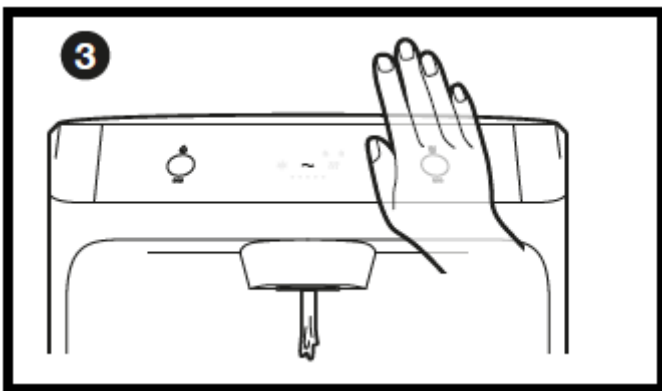

3. Remove your hand from the Selection Sensor. Then hold your hand over the Dispense Sensor to dispense water

NOTE: Dispensing will automatically be stopped after 25 seconds

PREPARING THE WATER SYSTEM

Your cooler can be used with a direct water line connection and filtration system. The filtration system can be installed prior to the water dispenser or can be installed inside the cabinet behind the door. Do not use water that is microbiologically unsafe or of unknown quality without adequate disinfection before or after the system

Fig. A WATER TUBE CONNECTION/ DISCONNECTION PROCEDURES

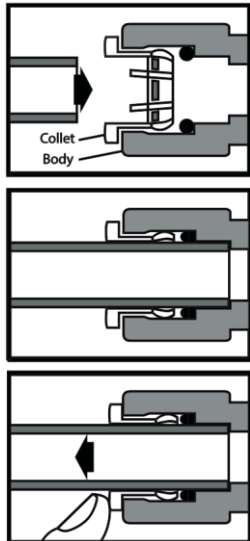

1. To connect, push tube through collet ring into body.
2. Tube must sit fully past o-ring.
3. To disconnect, hold collet ring against body and pull tube out.

1. Locate the Water Inlet Bulkhead at the back of the unit. Remove the plug and insert the water source tubing (1/4") into the bulkhead. Ensure the water line is secure.

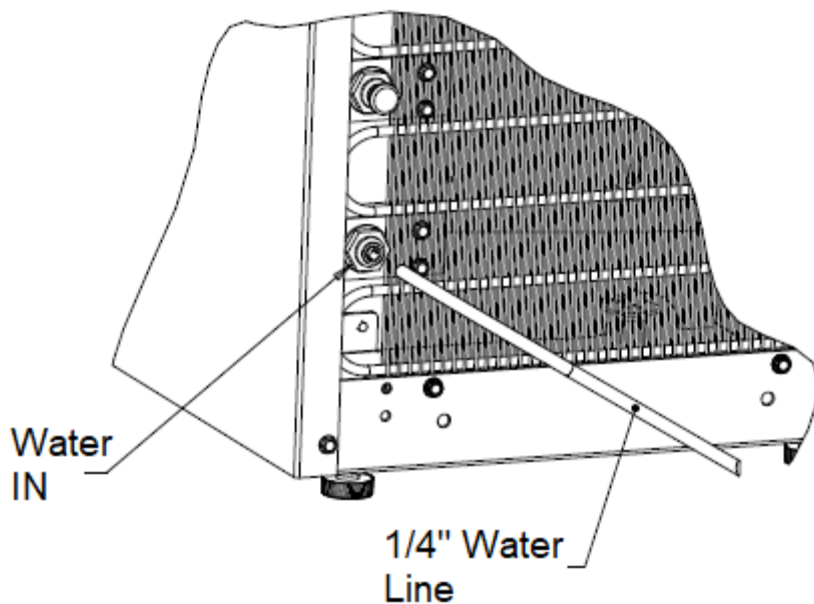

INITIAL SET UP

IMPORTANT! Make sure hot tank switch is off. Failure to fill the hot tank with water prior to turning on the hot tank will damage the unit

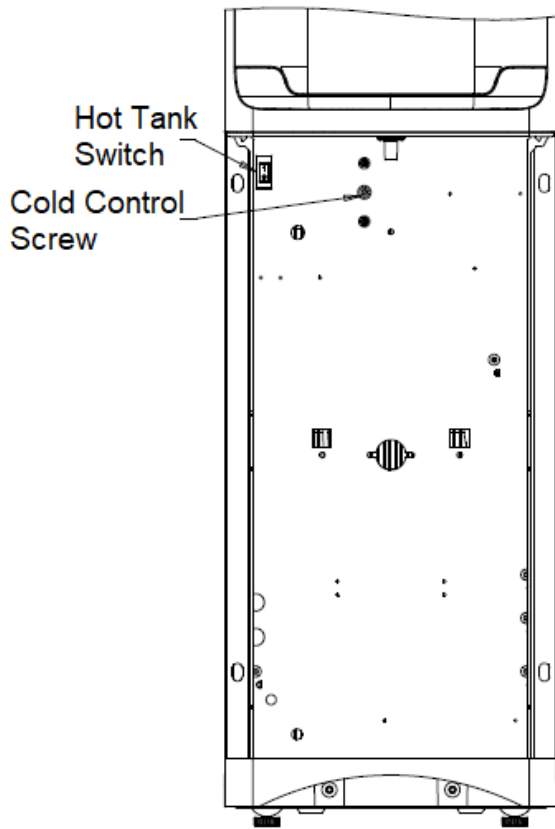

Access Door removed

1. Turn on the water supply to the unit and check for leaks.
2. Plug the dispenser into a grounded GFCI power outlet.
3. Please a container under the water dispense point. Follow instructions for operation of the water dispenser. It may take a few minutes to fill up the cold and hot water tanks.
4. Activate hot water dispense until water flows freely. Turn on hot water switch located behind the door on the panel. If you are not going to use hot water, turn the hot water switch OFF to conserve energy.
5. The first time the dispenser is used, you will have to wait at least 1 hour for cold water and 15 minutes for hot water.

NOTE: Please allow several minutes for solenoid valve to operate and fill up the water tanks before using the dispenser. If the water tanks are not full, water will not dispense.

ADDING FILTRATION (OPTIONAL)

Your OASIS cooler has the option to be fitted with various filtration options(not included).

1. Turn off the water supply and then dispense water into a cup to relieve pressure. Unplug the unit.
2. Remove access door from the front of the cooler. Identify suitable location to mount the filter - ensure that the filter is high enough to be pulled out from the filter head and removed. Once set, drill holes in the column support if required and use appropriate screws to attach the filter bracket to the column support

Note: The hardware to mount the filter head to the unit is not included

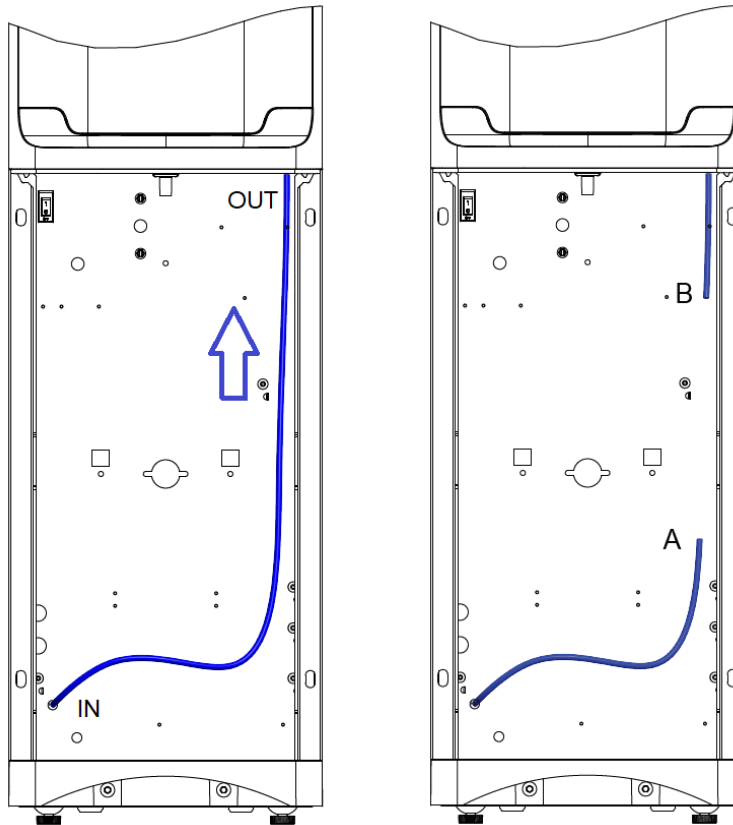

3. Cut the water line – ensure there is sufficient free length of tubing to make connections to the filter inlet and outlet.

4. Insert the water-in line (A) into the filter inlet of the filter head and then insert the water-out line (B) into the filter outlet. Ensure both lines are securely fitted.

Note: Refer to your filter or filter instructions to find the inlet and outlet for your chosen filter.

5. Turn the water source back on and reconnect power.

CLEANING AND MAINTENANCE

For maximum efficiency and performance, your water dispenser requires cleaning on a regular basis (ie. Every 6 months). Regular cleaning will prevent potential growth of bacteria and will maintain a hygienic environment. Never use harsh chemicals or abrasive cleaners.

Cleaning the Outside of the Water Dispenser

The outside of the dispenser may be wiped clean with a cleaning solution product or a mild soap and water mixture and a soft cloth. Rinse thoroughly with clean water and dry.

Cleaning the Drip Tray

The drip tray should be emptied and cleaned regularly to remove spotting and any mineral deposits.

To remove the drip tray, lift the tray upward about 2 inches before pulling it forward. Drain and clean with cleaning solution or a mild soap and water mixture. For tough deposits, add vinegar and let it soak until the deposits loosen. Then wash, rinse and dry thoroughly. Replace the grill on the drip tray and reinstall.

Cleaning the Condenser

Vacuum or sweep away the dust from the condenser coils. This will improve cooling and efficiency.

TROUBLESHOOTING

| PROBLEM | POSSIBLE CAUSE | SUGGESTION |
|---|--|--|
| Water does not dispense. | Dispenser is unplugged. | Plug the dispenser into a grounded GFCI power outlet. |
| | Main power supply is off. | Re-establish main power supply. |
| | Water supply is not turned on | Turn on water supply |
| | Water tanks are not full | Allow time for tanks to fill as sensors are being activated |
| | Solenoid valve is clogged/not working | Turn off water supply and unplug the dispenser. Contact your dealer |
| Cold water does not dispense. | Too much water consumed in a short period of time | Wait 15 minutes for the water to cool |
| | The ventilation around the dispenser is insufficient. | Provide at least 15 cm (6 in) of clearance on all sides of the dispenser. |
| | System has malfunctioned | Turn off water supply valve and unplug the dispenser. Contact dealer |
| Hot water does not dispense. | Hot water switch is OFF. | Turn hot water switch ON. |
| | Too much hot water has been consumed in short period of time. | Wait 15 minutes for the water to heat. |
| | System has malfunctioned. | Turn off water supply valve and unplug the dispenser. Contact dealer. |
| Dispenser is noisy during operation. | The dispenser is not level. | Place the dispenser on a level, flat surface. |
| | Dispenser is touching other objects. | Move dispenser away from other objects. |
| Water leaks from the water dispense point. | Solenoid valve has dirt/debris in it. | Contact Oasis Customer Service. 1-800-646-2747 |
| | The water dispense point has been damaged. | Contact Oasis Customer Service. 1-800-646-2747 |
| Water is dripping out of the dispenser and onto the floor. | The hot and/or cold tank drain caps are not fastened properly. | Tighten the drain cap. If the seal inside the drain cap is torn or damaged then replace with a new one. |
| | The hot or cold water tank is leaking. | Turn off water supply valve and unplug the dispenser. Contact dealer. |
| The water being dispensed has a strange taste. | This is not uncommon with new dispensers. | The taste usually goes away after the first several gallons have been used. |
| | Dispenser requires cleaning. | Contact Oasis Customer Service. 1-800-646-2747 |
| | Filter is old or water supply is tainted. | Replace filter and check water supply line for taste. |



CONTACTLESS POU HOT, COLD AND ROOM TEMPERATURE WATER DISPENSER

OASIS INTERNATIONAL

222 East Campus View Blvd.
Columbus, OH 43235

www.oasiscoolers.com

1-800-646-2747

